

CASE QUICK

TABLE OF CONTENTS

TABLE OF CONTENTS	PAGE 1-2
<i>CASE QUICK</i> COMPONENTS INFORMATION	PAGE 3
ORDERING INFORMATION	PAGE 4
ASSEMBLY INFORMATION	PAGE 5
INCH TO METRIC CONVERSION CHART	PAGE 6
BASE AND WALL CABINET VERTICAL LAYOUT	PAGE 7
VANITY VERTICAL LAYOUT	PAGE 8
DESK BASE VERTICAL LAYOUT	PAGE 9
BASE BLIND CORNER LAYOUT	PAGE 10
DOOR AND DRAWER HEIGHT LAYOUT	PAGE 11
HINGE PLACEMENT	PAGE 12-13
	PAGE 14
BASE CABINETS	
SINK BASE	
BASE FULL HEIGHT DOOR	1-1
STANDARD BASE	1-1
BASE 2 TOP DRAWER	1-2
	1-2
2 DRAWER BANK	1-3
3 DRAWER BANK	1-3
4 DRAWER BANK	1-4
5 DRAWER BANK	1-4
BASE TRAY CABINET	1-5
BASE TRAY CABINET W/ DRAWER	1-5
BASE BLIND CORNER	1-6
BASE BLIND CORNER W/ DRAWER	1-6
CORNER BASE LAZY SUSAN 45 DEGREE	1-7
CORNER BASE LAZY SUSAN 90 DEGREE	1-7
VANITY CABINETS	
VANITY SINK BASE	1-8
VANITY BASE FULL HEIGHT DOOR	1-8
VANITY BASE	1-9
VANITY 2 DRAWER BANK	1-9
VANITY 3 DRAWER BANK	1-10
VANITY 4 DRAWER BANK	1-10
VANITY SINK BASE W/ 3 DRAWERS	1-11
VANITY COMBINATION	1-11
MEDICINE CABINET	1-12
DESK BASE CABINETS	
DESK BASE FULL HEIGHT DOOR/ NO SHELF	1-13
DESK BASE	1-13
DESK BASE 2 DRAWER	1-14
DESK BASE 3 DRAWER	1-14
PENCIL DRAWER	1-15

CASE QUICK

TABLE OF CONTENTS

WALL CABINETS

WALL CABINET BALANCED PANEL HEIGHT INFORMATION	2-1
WALL CABINET HEIGHT 12-15	2-2
WALL CABINET HEIGHT 18-21	2-3
WALL CABINET HEIGHT 24-27	2-4
WALL CABINET HEIGHT 30-33	2-5
WALL CABINET HEIGHT 36-39	2-6
WALL CABINET HEIGHT 42-45	2-7
WALL CABINET HEIGHT 48-54	2-8
WALL CABINET HEIGHT 60-66	2-9

24" DEEP WALL CABINET

WALL CABINET HEIGHT 12-15-18	2-10
WALL CABINET HEIGHT 21-24-27	2-11
WALL CABINET HEIGHT 30-33-36	2-12

WALL CABINETS

WALL BLIND CORNER HEIGHT 24-27-30-33	2-13
WALL BLIND CORNER HEIGHT 36--39-42-45	2-14
WALL CORNER LAZY SUSAN 45 DEGREE	2-15
WALL CORNER SHELF 45 DEGREE	2-15
WALL CORNER LAZY SUSAN 90 DEGREE	2-15
WALL CORNER SHELF 90 DEGREE	2-15
WALL MICROWAVE CABINET	2-16

TALL CABINETS

UTILITY/PANTRY 24" DEEP	3-1
OVEN CABINET W/ DRAWER	3-2
TALL CABINET 12" DEEP	3-3
TALL CABINET 16" DEEP	3-4
TALL CABINET 21" DEEP	3-5

DRAWERS AND SHELVES

DRAWER BOX 12" DEEP	4-1
DRAWER BOX 16" DEEP	4-2
DRAWER BOX 20" DEEP	4-3
DRAWER BOX 22" DEEP	4-4
ADJUSTABLE SHELVES	4-5

CASE QUICK

MATERIAL SPECIFICATIONS

BOX COMPONENTS

All component parts are cut from the $\frac{3}{4}$ " material of your choosing, prefinished maple, white melamine, etc., and have an applied edgeband on all exposed edges. All boxes have solid tops and fully captured $\frac{1}{4}$ " back panels. One top nailer and one top drawer stretcher are supplied with each standard base cabinet. All standard wall cabinets are supplied with two nailers. All components are bored for the 32 mm system and dowel or confirmat construction. Dowels are provided.

DRAWERS

Each Standard Base and Standard Vanity Base includes one 4" (100mm) depth drawer box. Drawer box components are cut from $\frac{5}{8}$ " (16mm) double-sided white melamine or prefinished maple and have an applied edgeband on all top edges. Drawer bottoms are fully captured $\frac{1}{4}$ " (7mm) one-sided white melamine or prefinished maple. Drawer sides are bored for dowel construction.

SHELVES

Each Standard Base, Standard Vanity base, Blind Corner base and Base 2 Top Drawer cabinet includes one $\frac{3}{4}$ " (19mm) full depth adjustable shelf. Each Standard Wall cabinet includes a variable number of $\frac{3}{4}$ " (19mm) full depth adjustable shelves as pictured in the catalog. The Utility/Pantry cabinet and Tall Cabinet includes one fixed support shelf. All additional shelves are ordered separately.

CASE QUICK

ORDERING INFORMATION

1. CATALOG ITEMS

All catalog and non-catalog items will be built on a per order basis using COPPERWOOD order forms. We are not responsible for cabinet drawing “take-offs”, however, drawings for custom boxes are always appreciated.

2. PRICES

The prices printed in this catalog are for prefinished maple plywood cases. Please ask a sales representative for the current white melamine discount multiplier.

3. TERMS OF SALE

A 50% deposit is required to start your order. The balance is due when your order is ready to ship. Prompt payments speed delivery. High volume orders will be quoted on a per job basis.

4. DELIVERY

Orders will be shipped via common carrier. Shipping costs will be added to each order or paid by the customer at the receiving end. “Will Call” orders may be picked up Mon. – Fri. between 8:00 am and 3:00 pm.

5. LEAD TIMES

Every effort will be made to complete your order in 15 working days from the date of confirmed orders. For custom orders or unusually large orders, please contact a sales representative for more information.

6. ORDERING CABINETS

All orders and inquiries receive prompt handling. All orders and quote requests must be submitted using the order form at the back of this catalog and emailed to our sales desk. When writing your box description please use the following method:

WIDTH X HEIGHT X DEPTH

This is a standard size box:

Example: 3DB21 21 x Std x Std

This is a custom sized box:

Example: 3DB22 22 x 34.5 x 16

CASE QUICK

ASSEMBLY INFORMATION

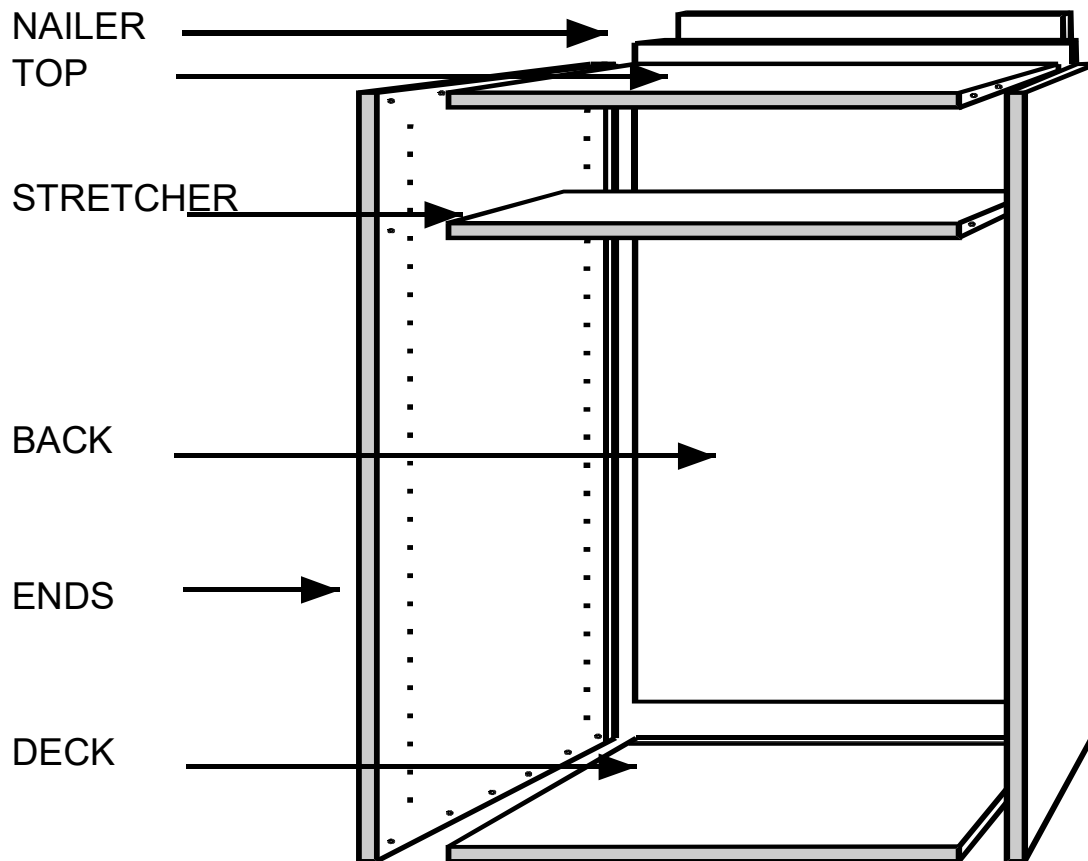

1. Place sides on a flat work surface and install hardware in desired locations. Apply glue in construction holes and back slot.
2. Apply glue and insert dowels into top, deck, drawer stretcher (where applicable) and assembly rail.
3. Insert top, deck, drawer stretcher (where applicable) and assembly rail into one side of the cabinet.
4. Slide back into position.
5. Place opposite side onto dowels and gently press into place.
6. Clamp and (or) screw box together checking for squareness. Secure back with staples or glue if necessary.

CASE QUICK

INCH TO METRIC CONVERSION CHART

CABINET BOX WIDTHS

INCH	METRIC
9"	229 mm
12"	305 mm
15"	381 mm
18"	457 mm
21"	533 mm
24"	610 mm
27"	686 mm
30"	762 mm
33"	838 mm
36"	914 mm
39"	990 mm
42"	1066 mm
45"	1143 mm
48"	1219 mm

U/P and TALL CABINETS TOTAL HEIGHT FROM FLOOR

84 = 2133 MM	PANEL SIZE = 2025 mm (79 3/4")
90 = 2286 MM	PANEL SIZE = 2178 mm (85 3/4")
96 = 2438 MM	PANEL SIZE = 2330 mm (91 3/4")

CABINET DEPTH CONVERSION CHART

BASE CABINETS	600 mm (23 5/8")
VANITY BASES	533 mm (21")
WALL CABINETS	305 mm (12")
Utility/Pantry CABINETS	600 mm (23 5/8")

THE ABOVE SIZES ARE CORRECT TO THE BEST OF OUR KNOWLEDGE. YOUR CABINET SIZES MAY VARY SLIGHTLY DUE TO THE NATURE OF THE MATERIAL.

BASE AND WALL CABINET VERTICAL LAYOUT

BOX MATERIAL IS 19 mm
WHITE 2-S MELAMINE.

DRAWER BOX MATERIAL IS
16 mm 2-S WHITE MELAMINE.

BACKS AND DRAWER BOTTOMS
ARE 7mm 1-S WHITE MELAMINE

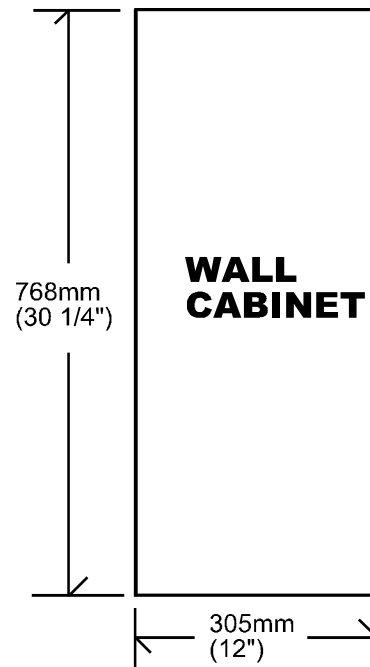

SUB TOP AND FILLER MATERIAL
SUPPLIED BY INSTALLER

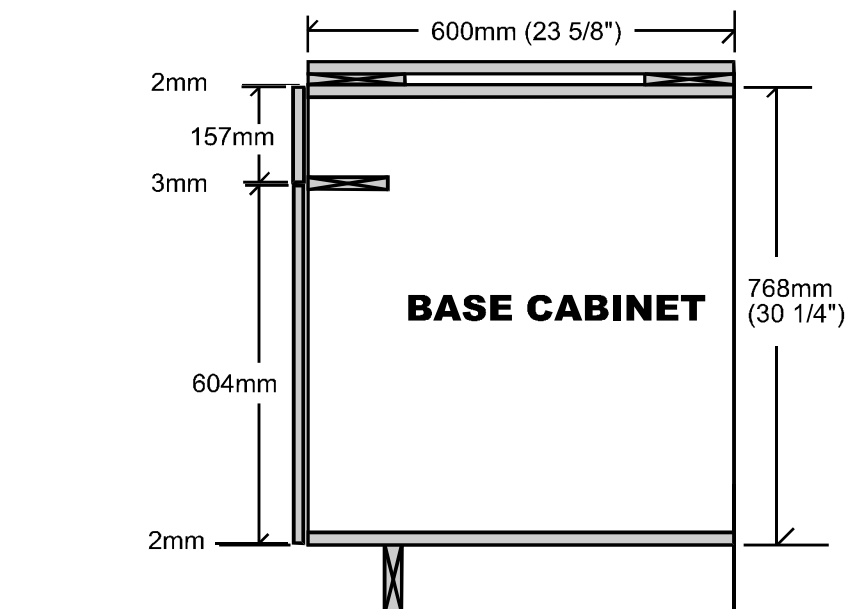

VANITY BASE VERTICAL LAYOUT

BOX MATERIAL IS 19 MM
WHITE 2-S MELAMINE.

DRAWER BOX MATERIAL IS
16 MM WHITE 2-S MELAMINE.

BACKS AND DRAWER BOTTOMS
ARE 7 mm 1-S WHITE MELAMINE

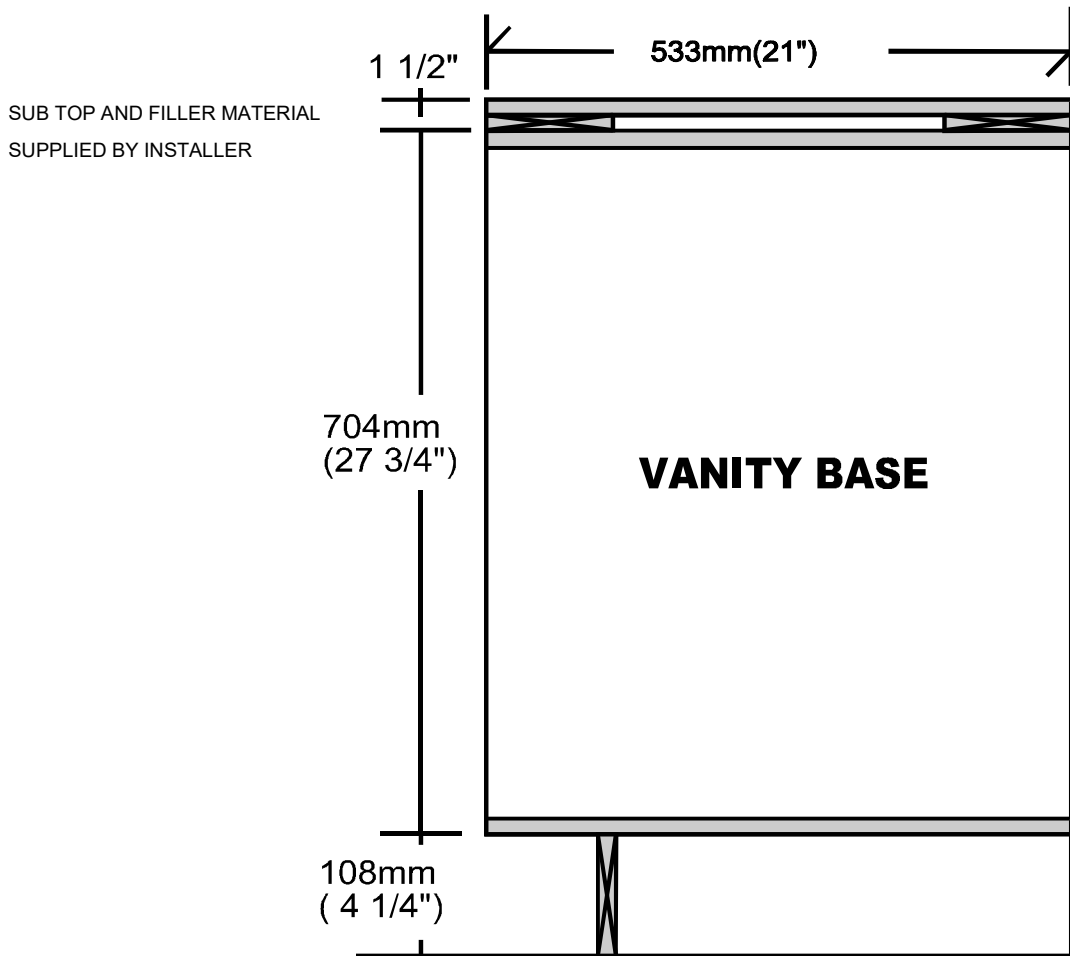

DESK BASE VERTICAL LAYOUT

BOX MATERIAL IS 19 MM
WHITE 2-S MELAMINE.

DRAWER BOX MATERIAL IS
16 MM WHITE 2-S MELAMINE.

BACKS AND DRAWER BOTTOMS
ARE 7 mm 1-S WHITE MELAMINE

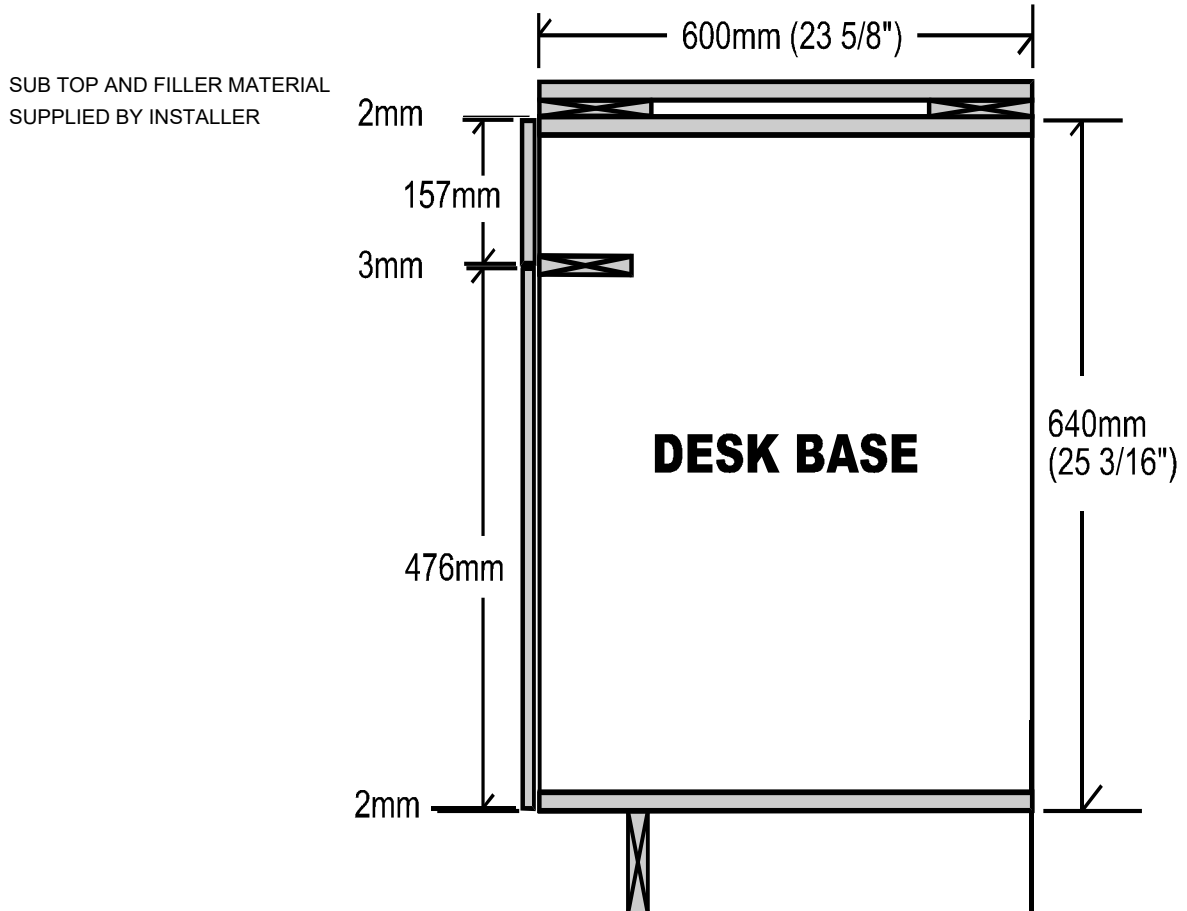

BASE BLIND CORNER LAYOUT

Base Blind Corner cabinet (BBC)

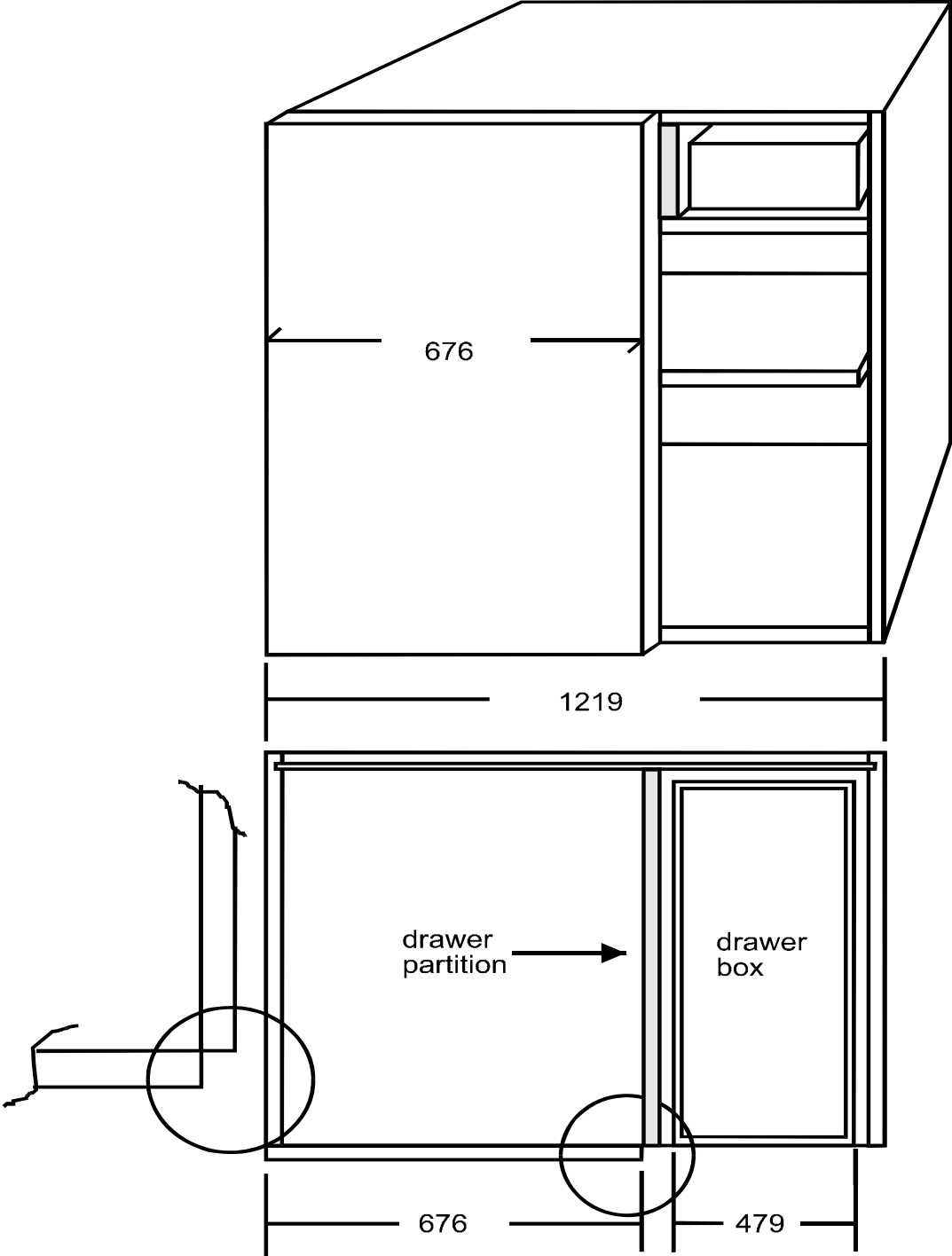

DOOR AND DRAWER HEIGHT LAYOUT

BASE BOX = 30 1/4" TALL

PD	B	2DB	3DB	4DB	5DB	B2TD	BFHD
4 3/8"	6 3/16"	15"	6 3/16 "	6 3/16 "	6 3/16"	6 3/16"	30 1/8"
	23 3/4"		11 13/16"	6 3/16"	5 7/8"	23 3/4"	
		15"	11 13/16"	6 3/16"	5 7/8"		
			11 3/16"	5 7/8"			
			5 7/8"				

DESK BASE BOX = 25 3/16" TALL

PD	DB	DB2D	DB3D	DB4D	DBND
4 3/8"	6 3/16"	12 1/2"	6 3/16"	6 3/16"	25 1/16"
	18 3/4"		6 3/16"	6 3/16"	
		12 1/2"	12 7/16"	6 3/16"	
		6 3/16"			

VANITY BASE BOX = 27 3/4" TALL

PD	VB	V2DB	V3DB	V4DB	VBFHD
4 3/8"	6 3/16"	13 11/16"	6 3/16"	6 3/16"	27 9/16"
	21 1/4"		10 9/16"	6 3/16"	
		13 11/16"	10 9/16"	6 3/16"	
		8 1/2"			

VANITY BASE = 27 3/4" TALL
VCOM - CENTER SINK

6 3/16"	6 3/16"	6 3/16"
21 1/4"		

VANITY BASE = 27 3/4" TALL
VS3D - SIDE SINK

6 3/16"	6 3/16"
21 1/4"	10 9/16"
	10 9/16"

DOOR AND DRAWER HEIGHT LAYOUT

VERTICAL LAYOUT FOR BALANCED WALL CABINETS
(APPROX. 2mm REVEAL TOP & BOTTOM)

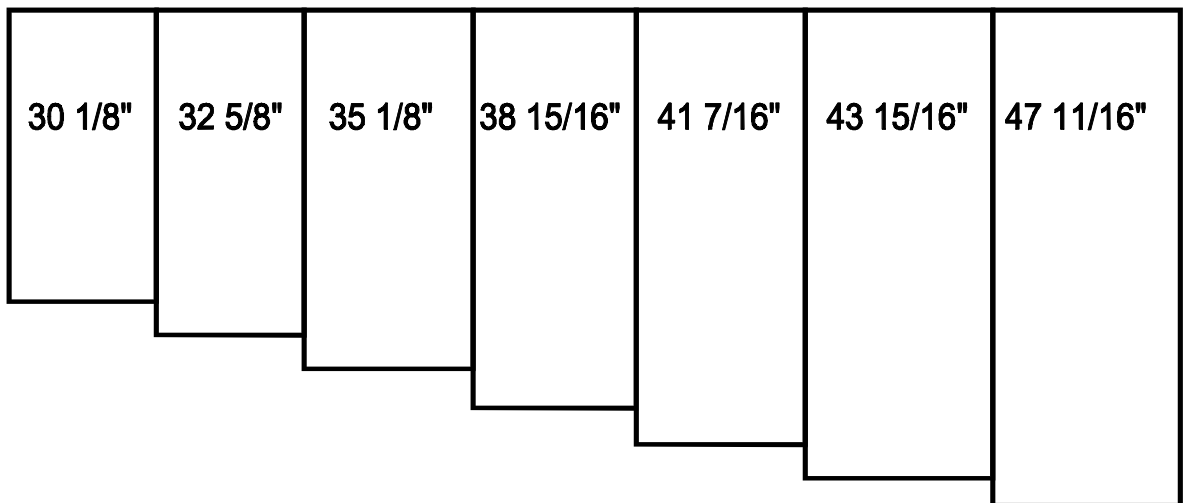
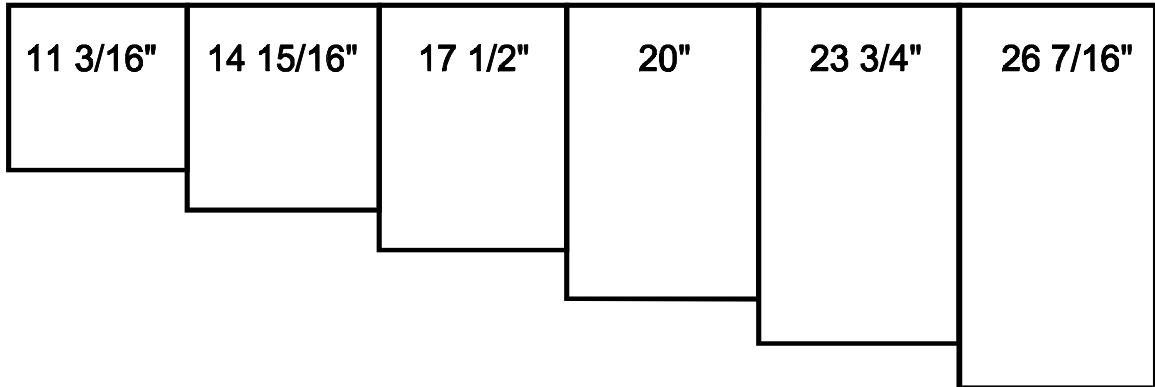

Tall box door sizes are determined by the size of the box minus a reveal of 2mm top and bottom. The doors are split based on the location of the fixed shelf.

The width of all cabinet doors is based on a 1.5 mm to 2mm reveal on each side of the cabinet.

A door and drawer front size information sheet is available to match the customer's order.

This sheet can be faxed or emailed to the customer or a specified door manufacturer on request.

Your actual sizes may vary depending on the reveal required by your specific job.

SUGGESTED HINGE PLACEMENT

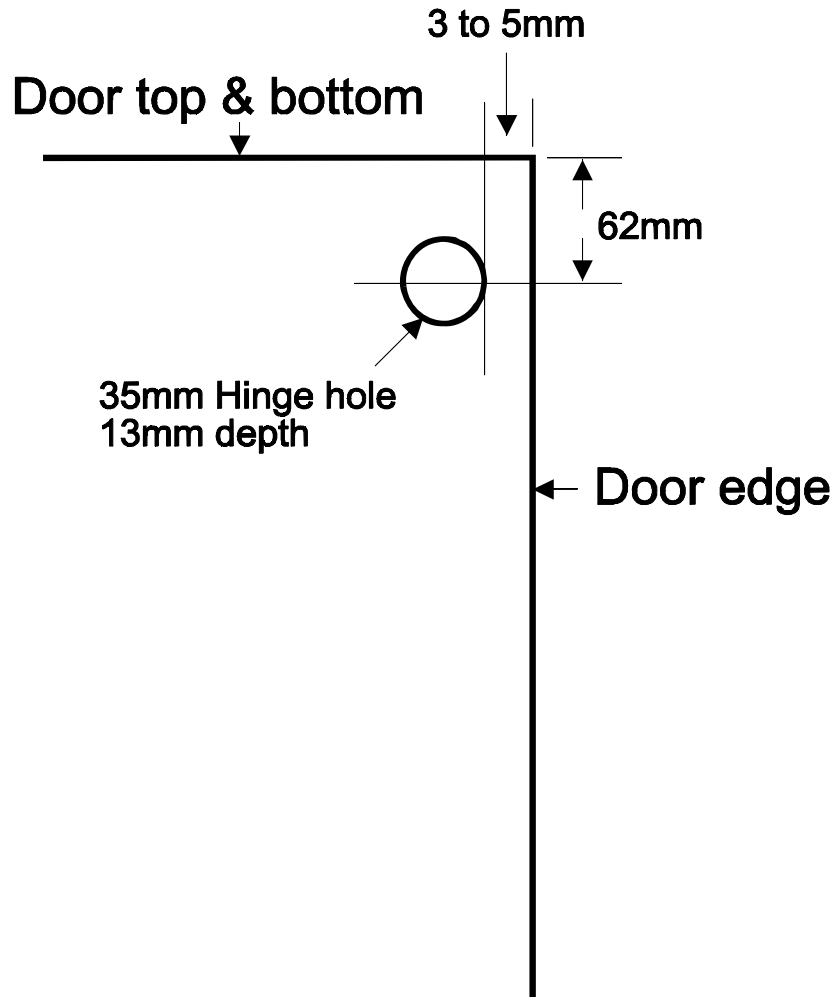

All door, drawer front and drilling information is provided to assist our customers. This information is provided only as a guide. COPPERWOOD LLC is not responsible for the use of these documents.

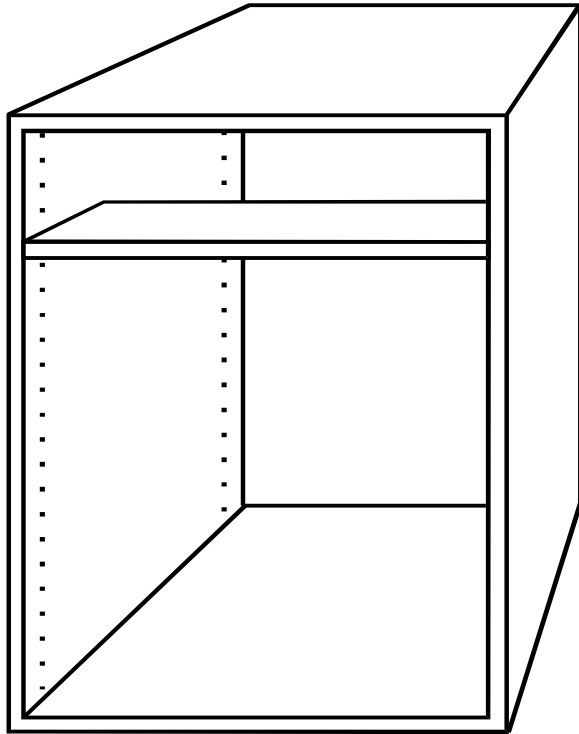

STANDARD SINK BASE
HEIGHT 768 mm (30 1/4)
DEPTH 600 mm (23 5/8)

WIDTH		WEIGHT
SB	06	40
SB	09	45
SB	12	50
SB	15	54
SB	18	59
SB	21	64
SB	24	68
SB	27	73
SB	30	78
SB	33	82
SB	36	87
SB	39	92
SB	42	96
SB	45	101
SB	48	106

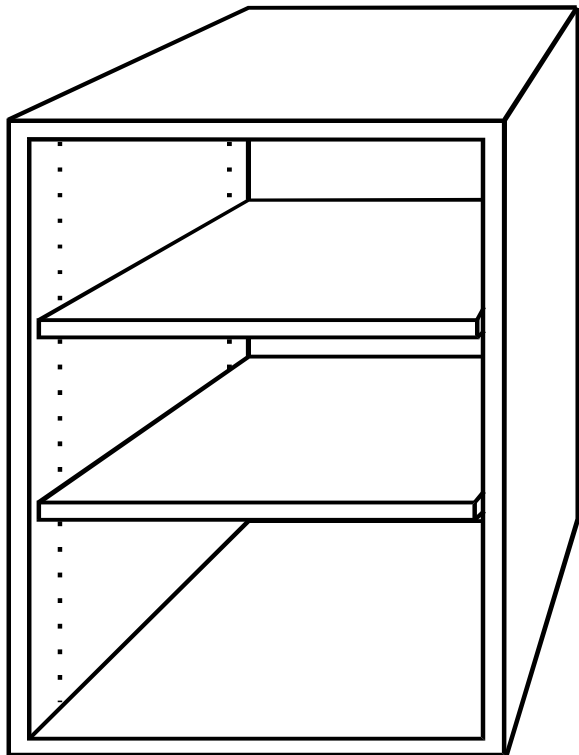

BASE FULL HEIGHT DOOR
HEIGHT 768 mm (30 1/4)
DEPTH 600 mm (23 5/8)

WIDTH		PRICE	WEIGHT
BFHD	06		46
BFHD	09		54
BFHD	12		62
BFHD	15		69
BFHD	18		77
BFHD	21		85
BFHD	24		92
BFHD	27		100
BFHD	30		108
BFHD	33		115
BFHD	36		123
BFHD	39		131
BFHD	42		138
BFHD	45		146
BFHD	48		154

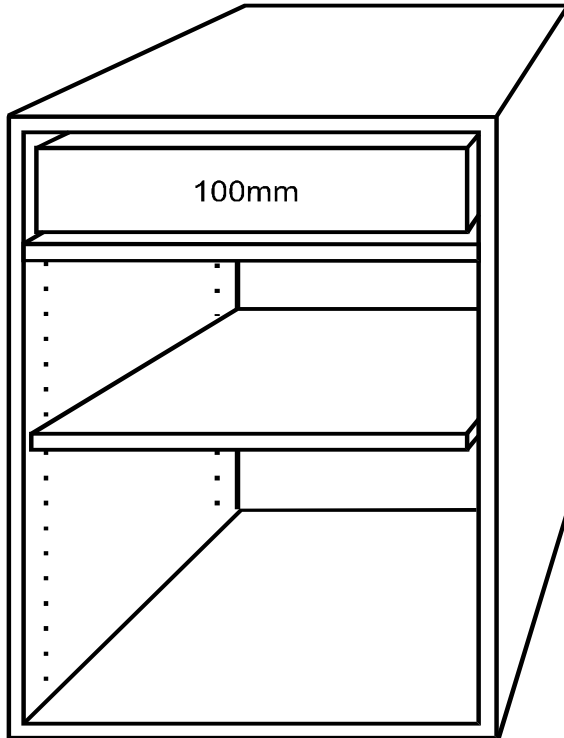

STANDARD BASE
HEIGHT 768 mm (30 1/4)
DEPTH 600 mm (23 5/8)

WIDTH	PRICE	WEIGHT
B 09		59
B 12		67
B 15		75
B 18		83
B 21		91
B 24		99
B 27		107
B 30		115
B 33		123
B 36		132
B 39		140
B 42		148
B 45		156
B 48		164

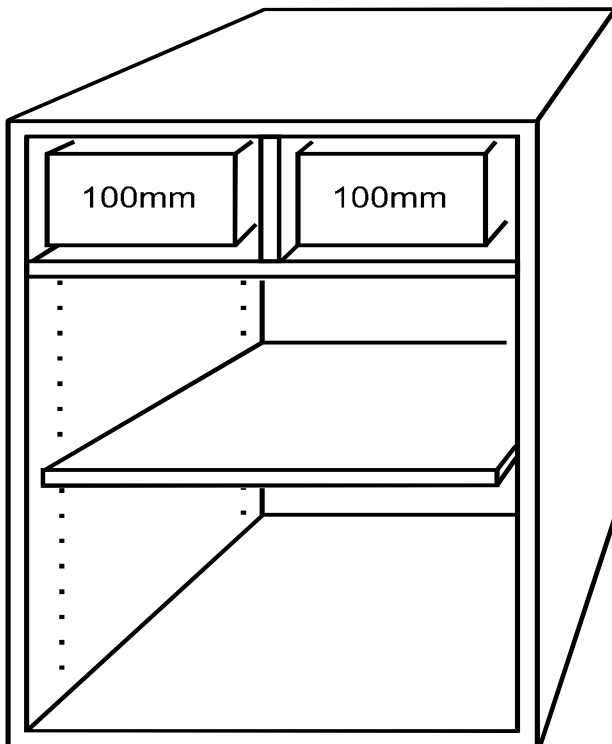

BASE 2 TOP DRAWERS
HEIGHT 768 mm (30 1/4)
DEPTH 600 mm (23 5/8)

WIDTH	PRICE	WEIGHT
B2TD 24		97
B2TD 27		104
B2TD 30		112
B2TD 33		118
B2TD 36		126
B2TD 39		132
B2TD 42		140
B2TD 45		146
B2TD 48		155

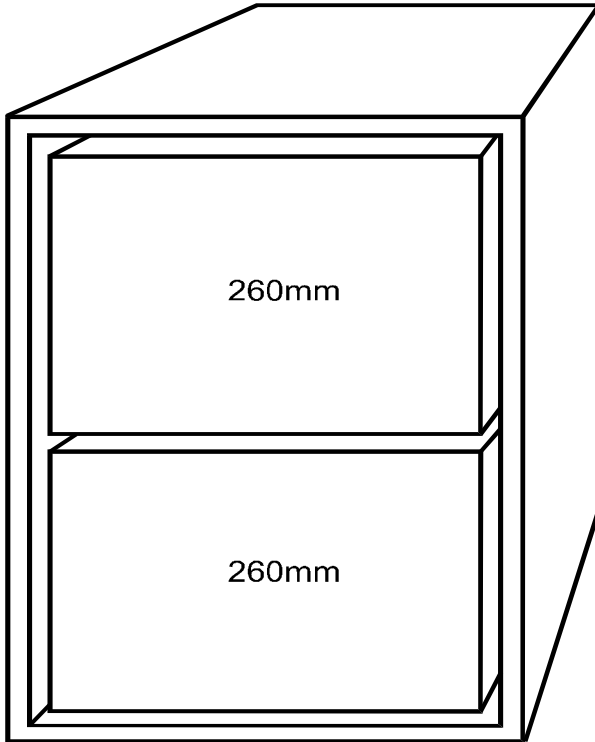

2 DRAWER BANK
HEIGHT 768 mm (30 1/4)
DEPTH 600 mm (23 5/8)

WIDTH	PRICE	WEIGHT
2DB 15		85
2DB 18		93
2DB 21		101
2DB 24		108
2DB 27		116
2DB 30		123
2DB 33		131
2DB 36		139

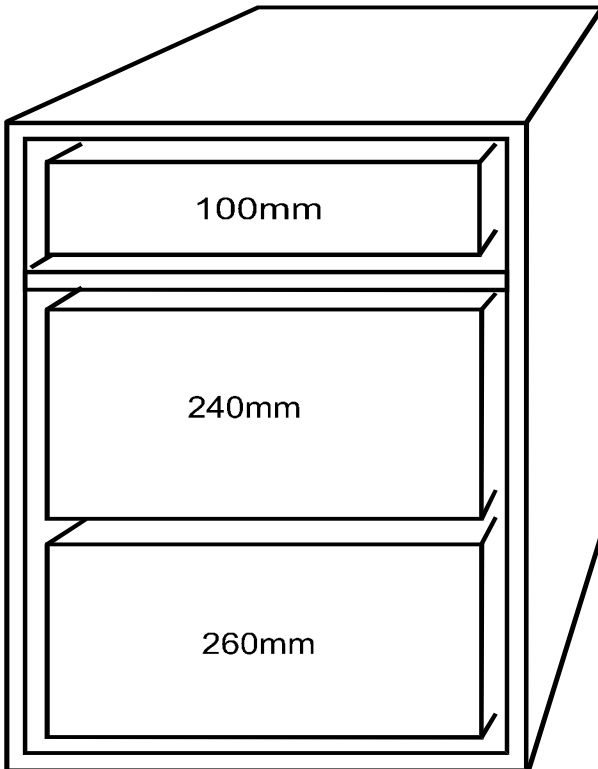

3 DRAWER BANK
STANDARD BASE
HEIGHT 768 mm (30 1/4)
DEPTH 600 mm (23 5/8)

WIDTH	PRICE	WEIGHT
3DB 09		76
3DB 12		85
3DB 15		93
3DB 18		102
3DB 21		111
3DB 24		120
3DB 27		129
3DB 30		137
3DB 33		146
3DB 36		155
3DB 39		164
3DB 42		173
3DB 45		181
3DB 48		190

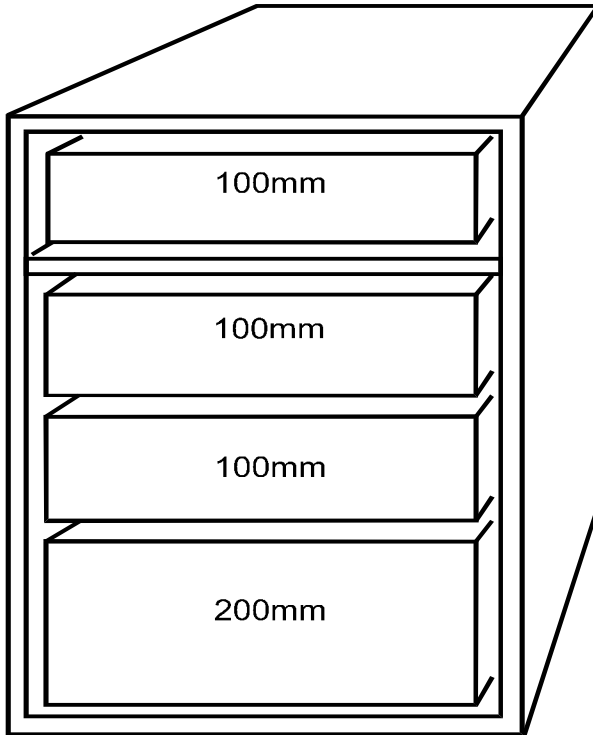

4 DRAWER BANK
HEIGHT 768 mm (30 1/4)
DEPTH 600 mm (23 5/8)

WIDTH	PRICE	WEIGHT
4DB 09		74
4DB 12		83
4DB 15		92
4DB 18		101
4DB 21		110
4DB 24		119
4DB 27		128
4DB 30		137
4DB 33		146
4DB 36		155

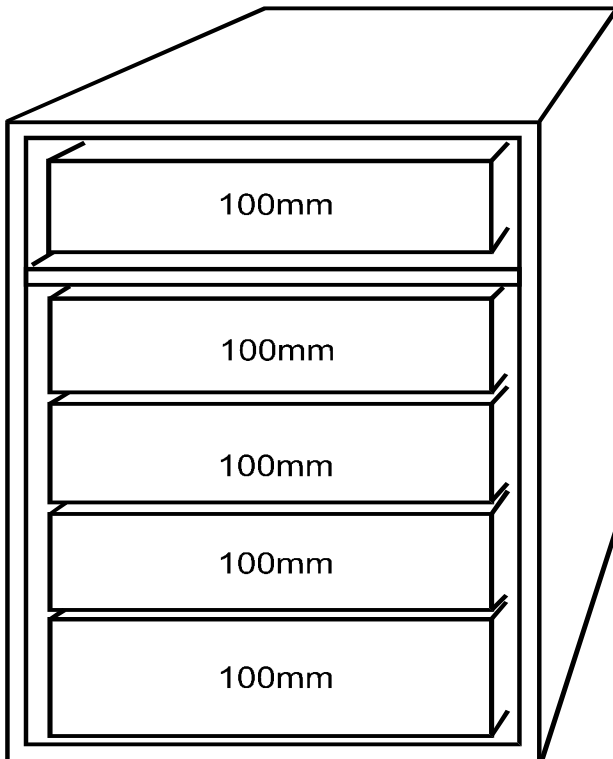

5 DRAWER BANK
HEIGHT 768 mm (30 1/4)
DEPTH 600 mm (23 5/8)

WIDTH	PRICE	WEIGHT
5DB 09		76
5DB 12		85
5DB 15		95
5DB 18		104
5DB 21		114
5DB 24		123
5DB 27		133
5DB 30		142
5DB 33		152
5DB 36		161

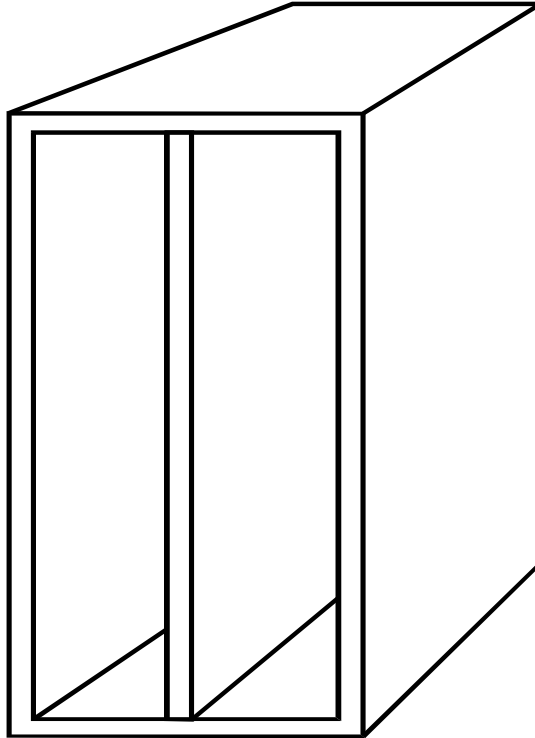

3/4" Divider in 12"-15" only

BASE TRAY CABINET
HEIGHT 768 mm (30 1/4)
DEPTH 600 mm (23 5/8)

WIDTH	PRICE	WEIGHT
BTFHD 06		49
BTFHD 09		58
BTFHD 12		62
BTFHD 15		66

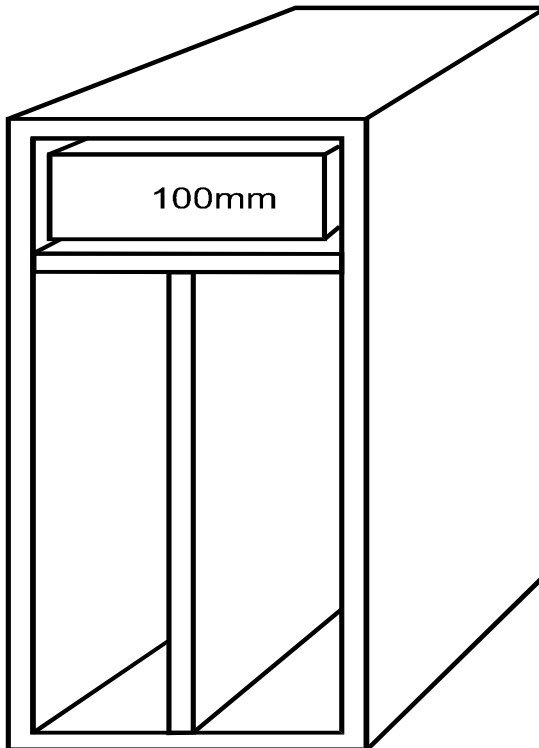

3/4" Divider in 12"-15" only

BASE TRAY/DRAWER
HEIGHT 768 mm (30 1/4)
DEPTH 600 mm (23 5/8)

WIDTH	PRICE	WEIGHT
BT/DW 09		61
BT/DW 12		67
BT/DW 15		72

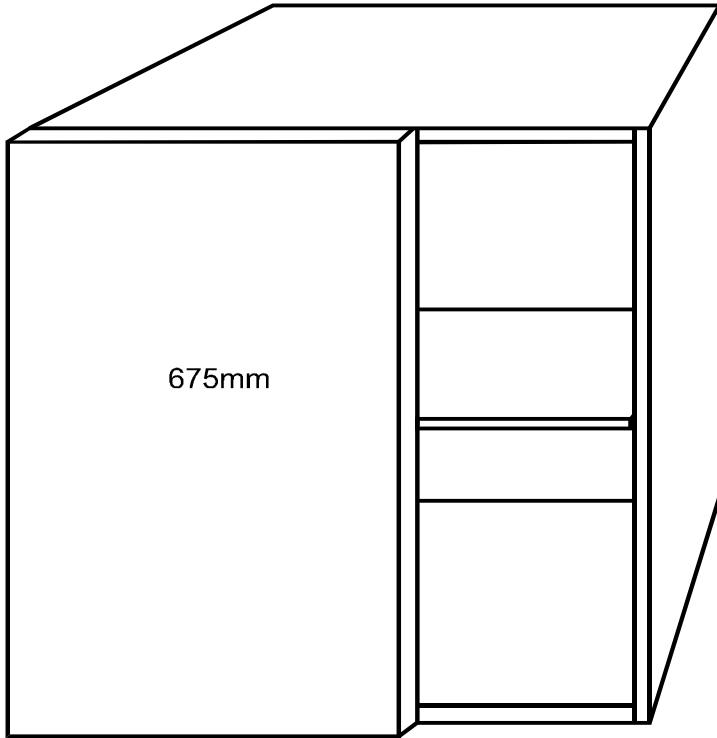

BASE BLIND CORNER
HEIGHT 768 mm (30 1/4)
DEPTH 600 mm (23 5/8)

WIDTH	PRICE	WEIGHT
BBC	33	116
BBC	36	122
BBC	39	150
BBC	42	156
BBC	45	162
BBC	48	168

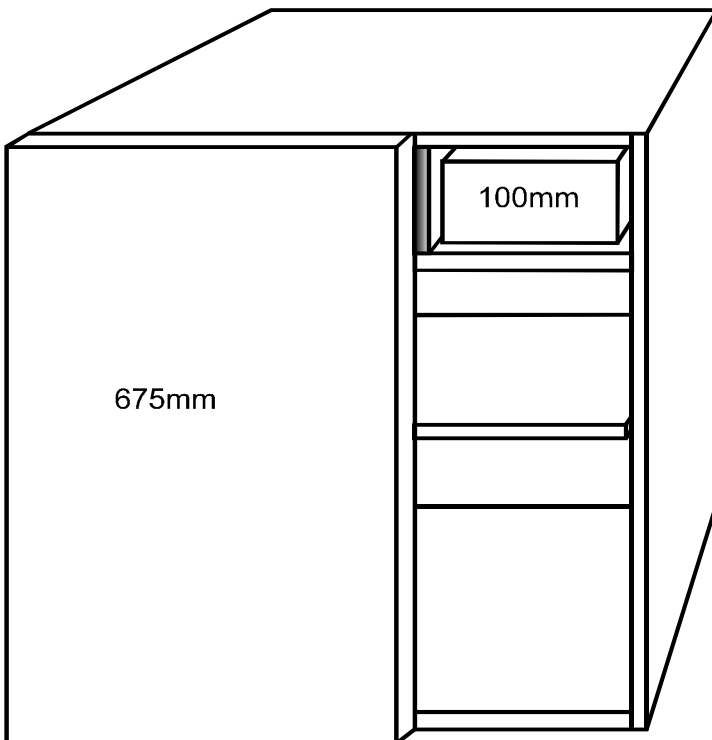

BASE BLIND CORNER /DW
HEIGHT 768 mm (30 1/4)
DEPTH 600 mm (23 5/8)

WIDTH	PRICE	WEIGHT
BBC/DW	36	130
BBC/DW	39	137
BBC/DW	42	144
BBC/DW	45	151
BBC/DW	48	158

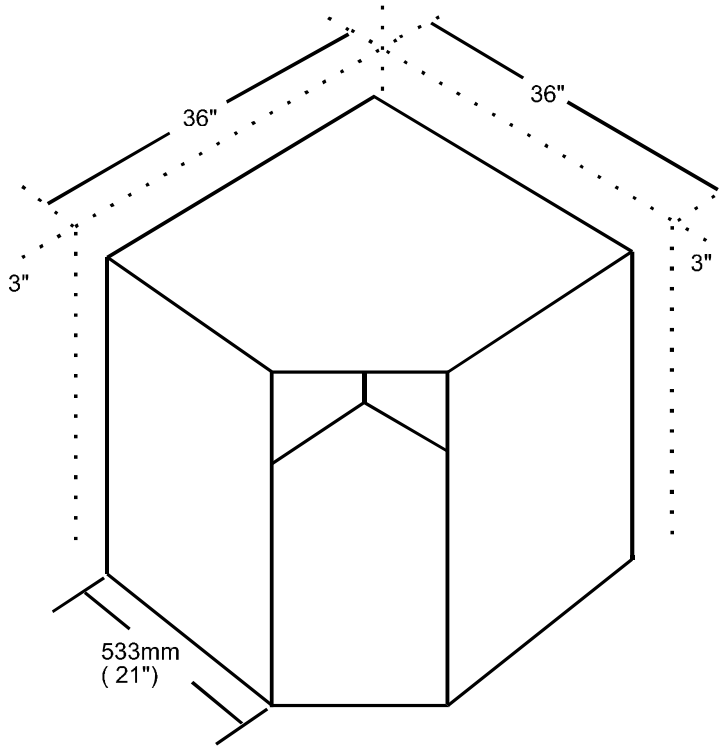

**CORNER BASE
LAZY SUSAN 45 DEGREE
HEIGHT 768 mm (30 1/4)
DEPTH 600 mm (23 5/8)**

WIDTH	PRICE	WEIGHT
CB/LS 45		129

WIDTH	PRICE	WEIGHT
CB/S 45		151

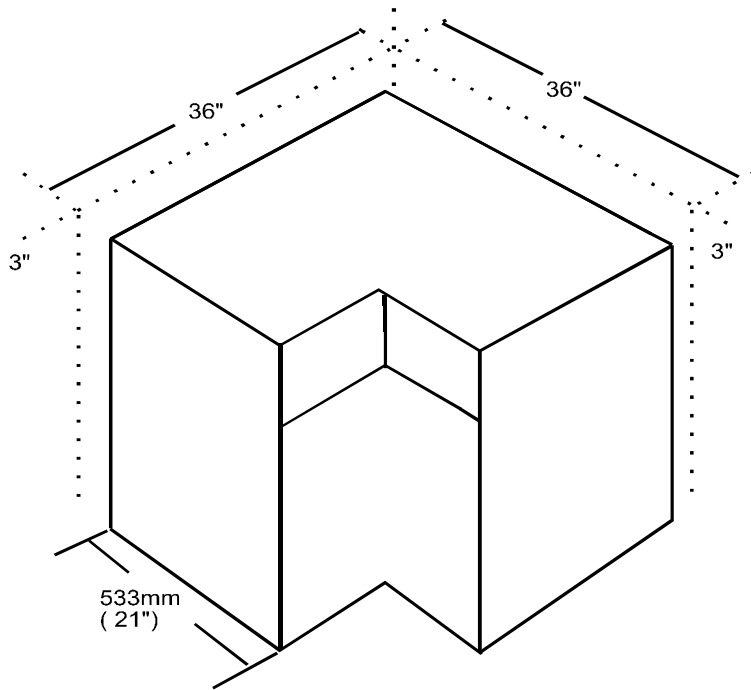

**CORNER BASE
LAZY SUSAN 90 DEGREE
HEIGHT 768 mm (30 1/4)
DEPTH 600 mm (23 5/8)**

WIDTH	PRICE	WEIGHT
CB/LS 90		129

WIDTH	PRICE	WEIGHT
CB/S 90		151

Install optional shelf when assembling cabinet

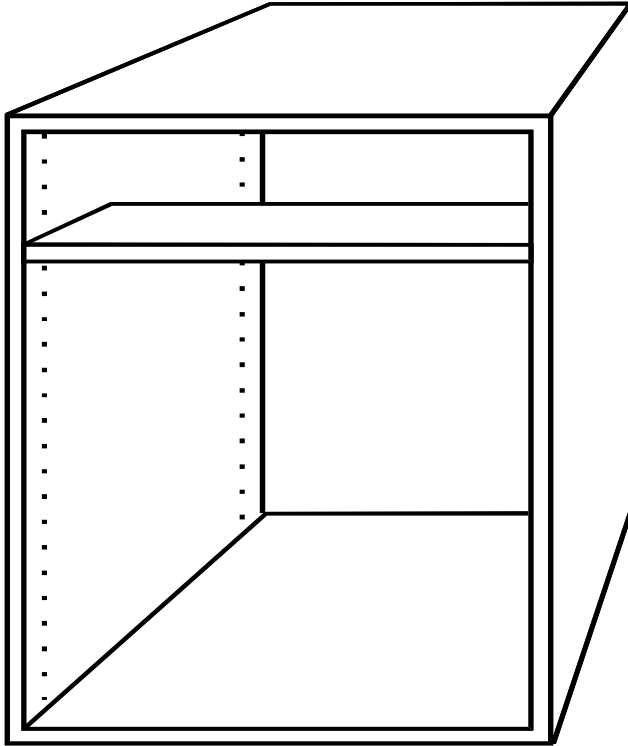

VANITY SINK BASE
HEIGHT 704 mm (27 3/4)
DEPTH 533 mm (21)

WIDTH	PRICE	WEIGHT
VSB 09		37
VSB 12		41
VSB 15		46
VSB 18		50
VSB 21		54
VSB 24		58
VSB 27		62
VSB 30		67
VSB 33		71
VSB 36		75
VSB 39		79
VSB 42		83
VSB 45		88
VSB 48		92

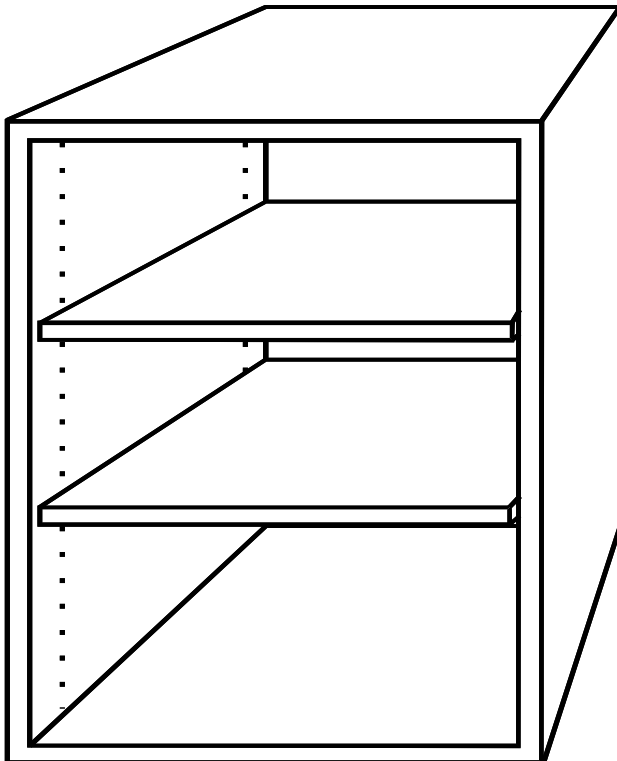

VANITY BASE
FULL HEIGHT DOOR
HEIGHT 704 mm (27 3/4)
DEPTH 533 mm (21)

WIDTH	PRICE	WEIGHT
VBFD 09		45
VBFD 12		52
VBFD 15		59
VBFD 18		65
VBFD 21		72
VBFD 24		79
VBFD 27		86
VBFD 30		93
VBFD 33		100
VBFD 36		106

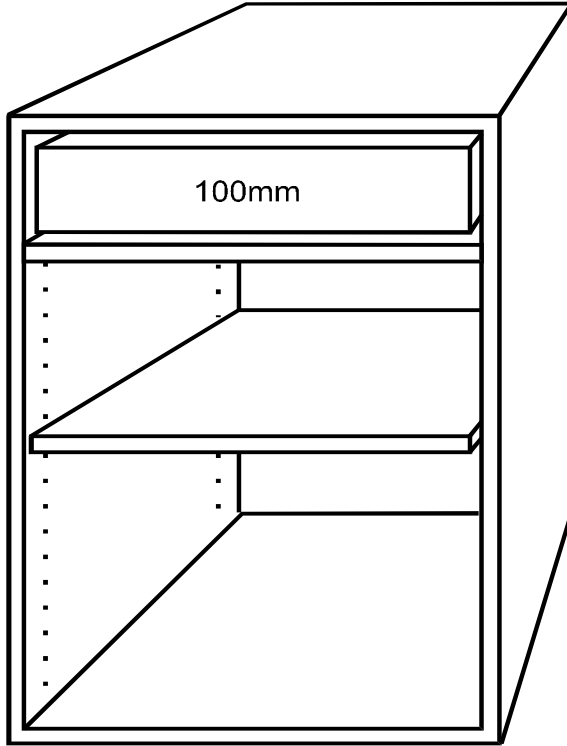

VANITY BASE
HEIGHT 704 mm (27 3/4)
DEPTH 533 mm (21)

WIDTH		PRICE	WEIGHT
VB	09		49
VB	12		57
VB	15		64
VB	18		71
VB	21		79
VB	24		86
VB	27		93
VB	30		100
VB	33		108
VB	36		115
VB	39		122
VB	42		130
VB	45		137
VB	48		144

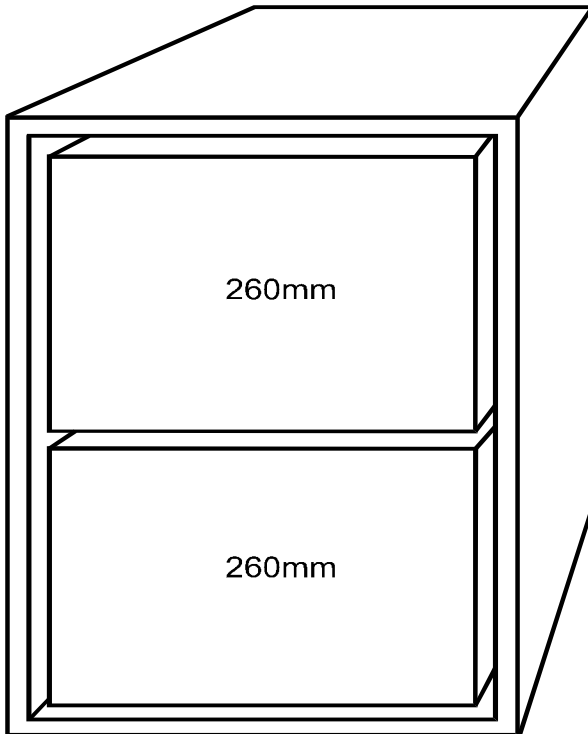

VANITY 2 DRAWER BANK
HEIGHT 704 mm (27 3/4)
DEPTH 533 mm (21)

WIDTH		PRICE	WEIGHT
V2DB	18		82
V2DB	21		89
V2DB	24		96
V2DB	27		103
V2DB	30		110
V2DB	33		117
V2DB	36		124

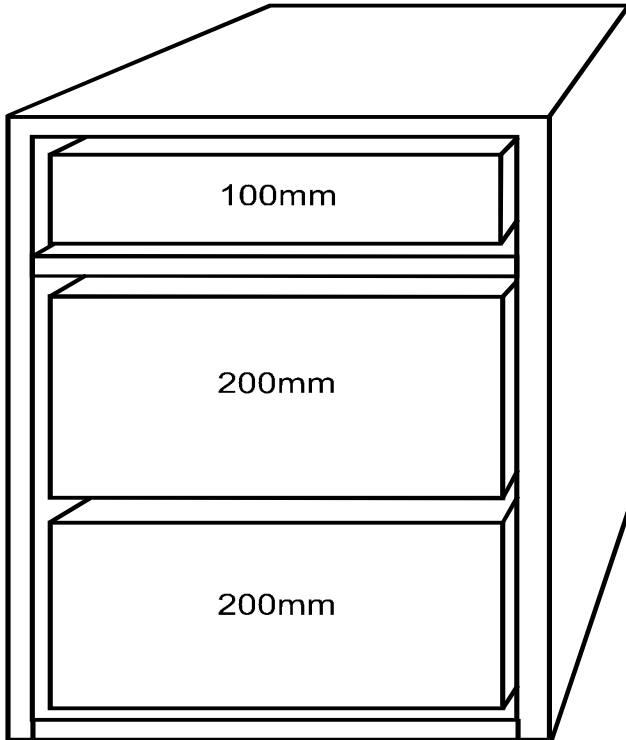

VANITY 3 DRAWER BANK
HEIGHT 704 mm (27 3/4)
DEPTH 533 mm (21)

WIDTH	PRICE	WEIGHT
V3DB 12		71
V3DB 15		78
V3DB 18		86
V3DB 21		94
V3DB 24		102
V3DB 27		110
V3DB 30		118
V3DB 33		126
V3DB 36		133

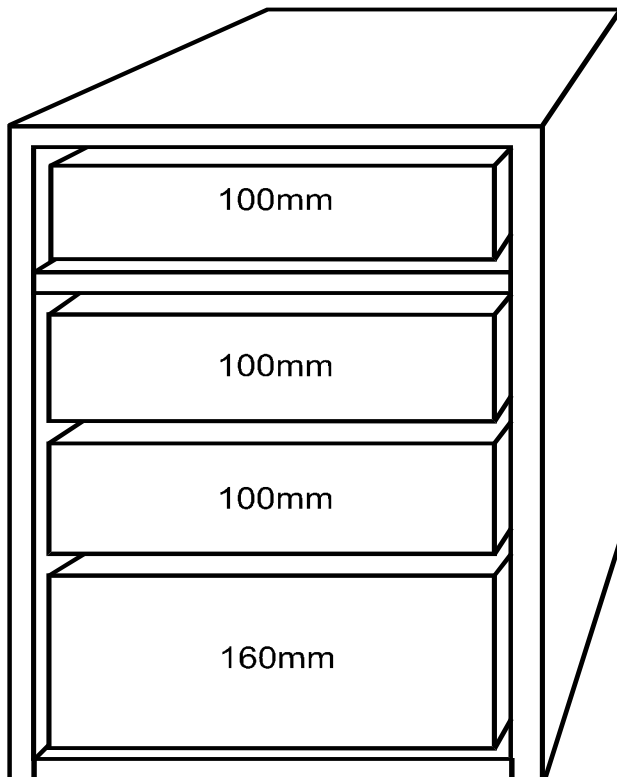

VANITY 4 DRAWER BANK
HEIGHT 704 mm (27 3/4)
DEPTH 533 mm (21)

WIDTH	PRICE	WEIGHT
V4DB 12		70
V4DB 15		78
V4DB 18		86
V4DB 21		95
V4DB 24		103
V4DB 27		111
V4DB 30		119
V4DB 33		127
V4DB 36		135

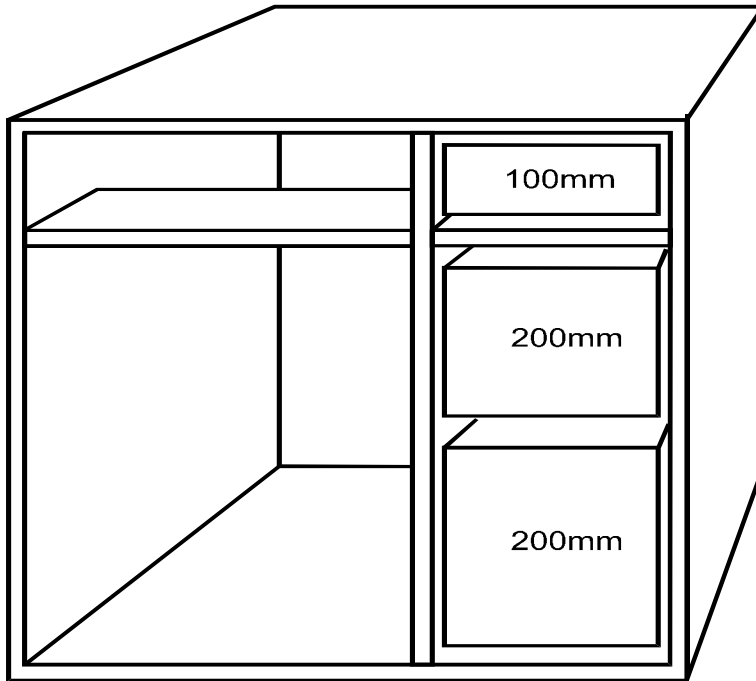

VANITY SINK 3 DRAWERS

HEIGHT 704 mm (27 3/4)

DEPTH 533 mm (21)

WIDTH	PRICE	WEIGHT
VS3D 36		112
VS3D 42		120
VS3D 48		128

18" Sink Base

Variable Drawer Widths

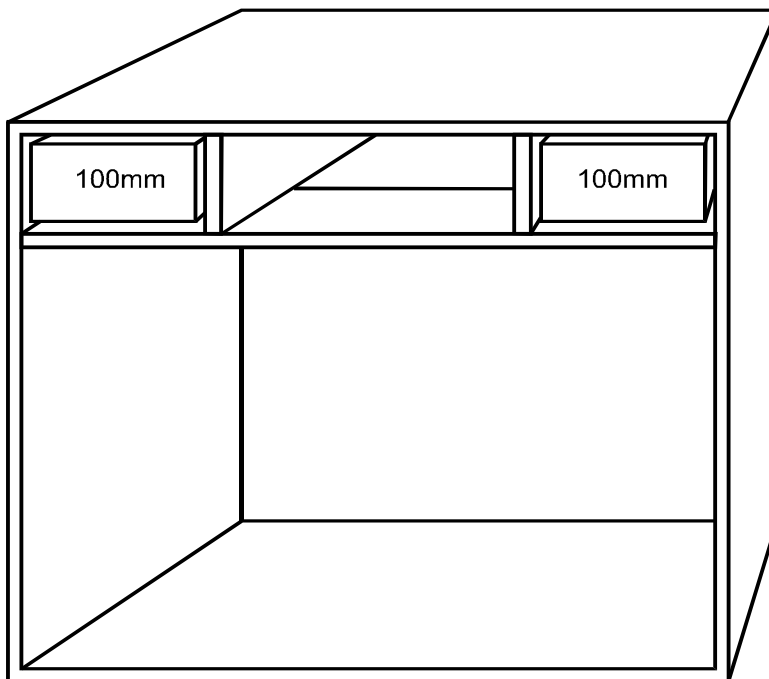

VANITY COMBINATION

HEIGHT 704 mm (27 3/4)

DEPTH 533 mm (21)

WIDTH	PRICE	WEIGHT
VCOM 36		90
VCOM 42		101
VCOM 48		111
VCOM 54		121

18" Sink Base Variable Drawer Widths

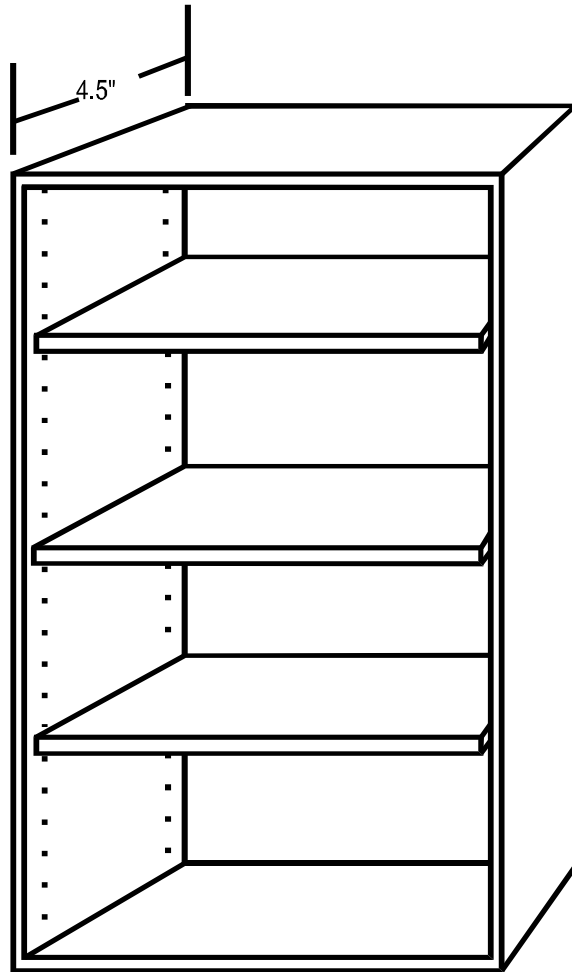

MEDICINE CABINET

DEPTH 115 mm (4 1/2")

WIDTH	PRICE	WEIGHT
MED1524		17
MED1824		20
MED2124		23
MED2424		26
MED1530		19
MED1830		22
MED2130		25
MED2430		28
MED1536		21
MED1836		24
MED2136		27
MED2436		30

ALL MEDICINE
CABINETS

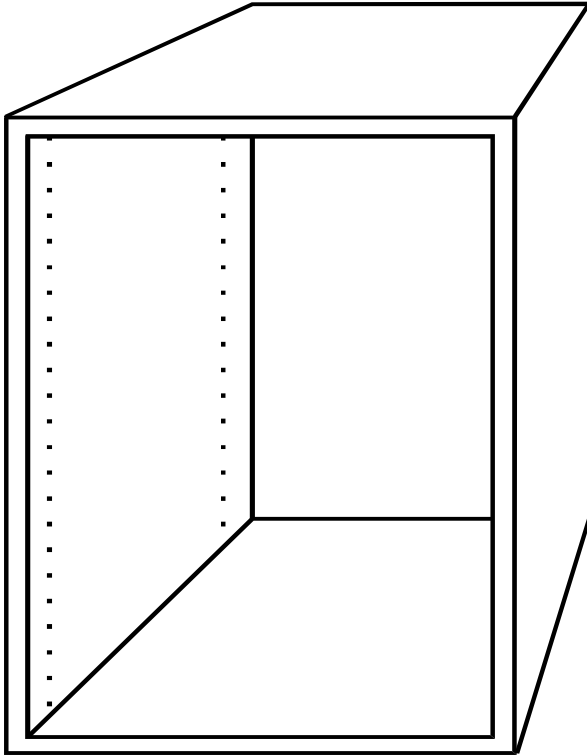

DESK BASE
FULL HEIGHT DOOR (no shelf)
HEIGHT 640 mm (25 3/16)
DEPTH 600 mm (23 5/8)

WIDTH	PRICE	WEIGHT
DBFHD 12		43
DBFHD 15		47
DBFHD 18		51
DBFHD 21		55
DBFHD 24		59
DBFHD 27		64
DBFHD 30		68
DBFHD 33		72
DBFHD 36		76
DBFHD 39		81
DBFHD 42		85
DBFHD 45		89
DBFHD 48		93

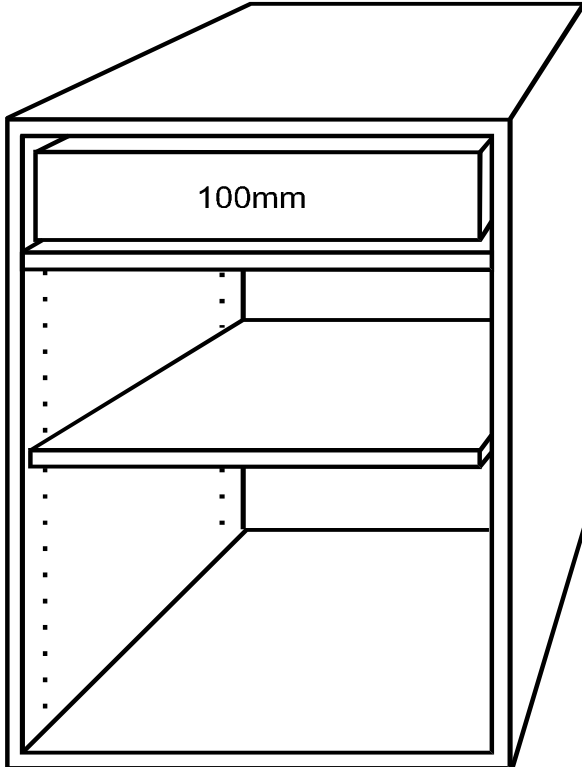

DESK BASE 1 DRAWER
HEIGHT 640 mm (25 3/16)
DEPTH 600 mm (23 5/8)

WIDTH	PRICE	WEIGHT
DB 12		50
DB 15		55
DB 18		60
DB 21		65
DB 24		70
DB 27		76
DB 30		81
DB 33		86
DB 36		91
DB 39		96
DB 42		102

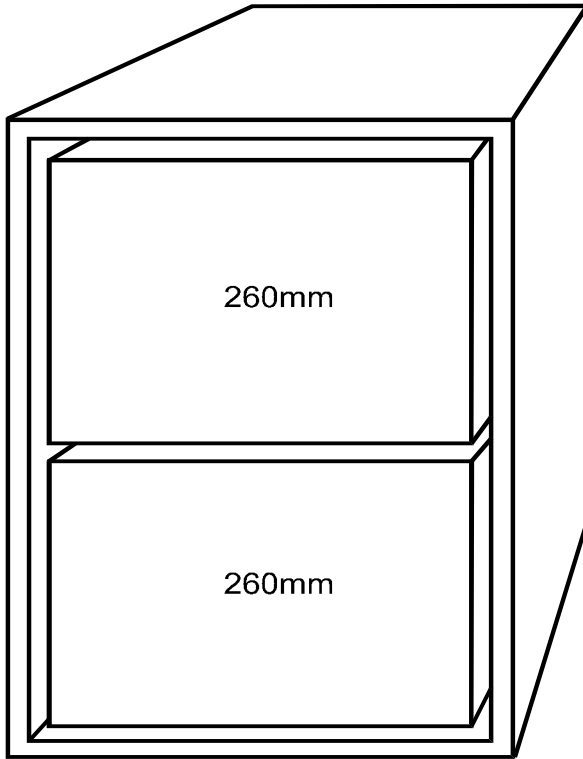

DESK BASE 2 DRAWER
HEIGHT 640 mm (25 3/16)
DEPTH 600 mm (23 5/8)

WIDTH	PRICE	WEIGHT
DB2D 12		72
DB2D 15		79
DB2D 18		87
DB2D 21		94
DB2D 24		102
DB2D 27		109
DB2D 30		117
DB2D 33		124
DB2D 36		132
DB2D 39		139
DB2D 42		147
DB2D 45		154
DB2D 48		162

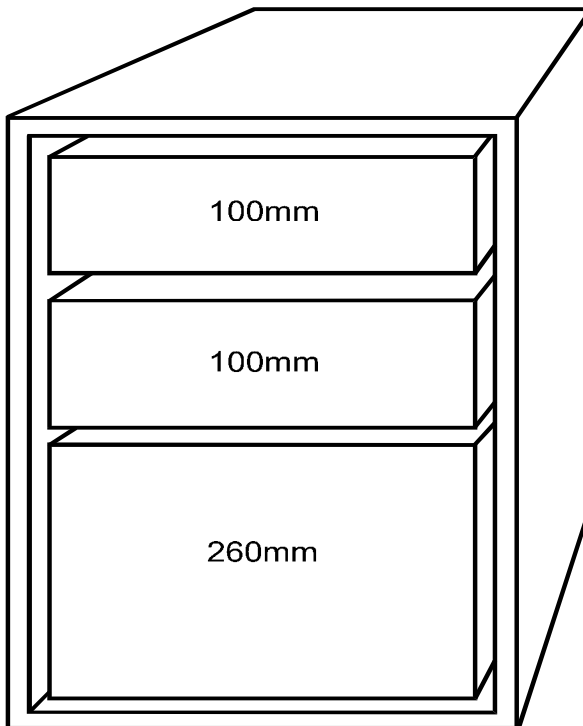

DESK BASE 3 DRAWER
HEIGHT 640 mm (25 3/16)
DEPTH 600 mm (23 5/8)

WIDTH	PRICE	WEIGHT
DB3D 12		71
DB3D 15		79
DB3D 18		87
DB3D 21		95
DB3D 24		103
DB3D 27		110
DB3D 30		118
DB3D 33		126
DB3D 36		134
DB3D 39		142
DB3D 42		149
DB3D 45		157
DB3D 48		165

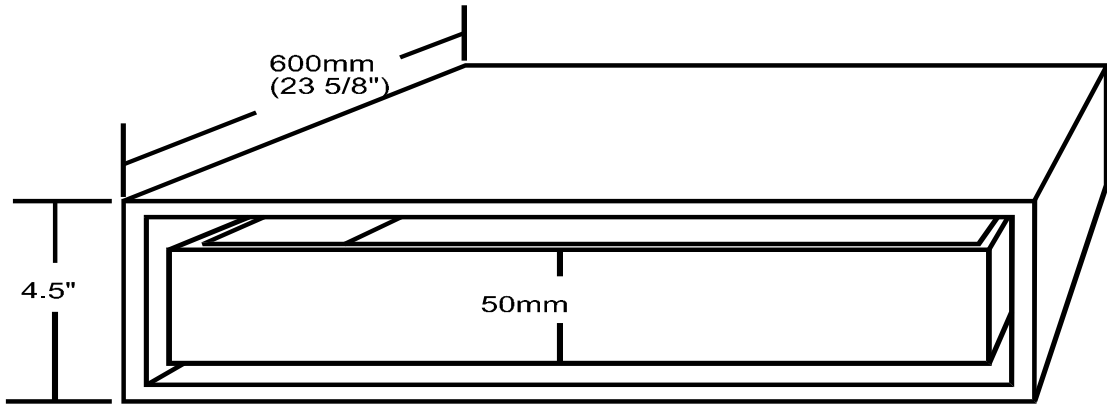

PENCIL DRAWER
HEIGHT 115MM (4 1/2")
DEPTH 600 mm (23 5/8)

WIDTH	PRICE	WEIGHT
PD21		37
PD24		41
PD27		45
PD30		50
PD33		54
PD36		59
PD39		63
PD42		67

WALL CABINET HEIGHT INFORMATION FOR BALANCED PANELS

WALL 12	NET:288MM	11.33"
WALL 15	NET:384MM	15.11"
WALL 18	NET:448MM	17.63"
WALL 21	NET:512MM	20.15"
WALL 24	NET:608MM	23.93"
WALL 27	NET:672MM	26.45"
WALL 30	NET:768MM	30.23"
WALL 33	NET:832MM	32.75"
WALL 36	NET:896MM	35.27"
WALL 39	NET:992MM	39.05"
WALL 42	NET:1056MM	41.57"
WALL 45	NET:1120MM	44.09"
WALL 48	NET:1216MM	47.87"

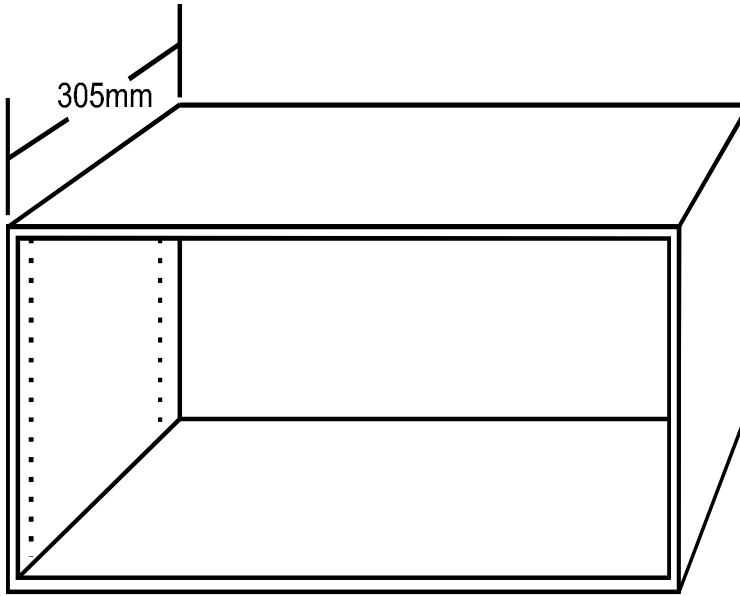

STANDARD WALL CABINET
HEIGHT 288 mm (11.33")
DEPTH 305 mm (12)

WIDTH x HEIGHT	PRICE	WEIGHT
W0912		13
W1212		15
W1512		18
W1812		21
W2112		23
W2412		26
W2712		28
W3012		31
W3312		33
W3612		36
W3912		39
W4212		41
W4512		44
W4812		46

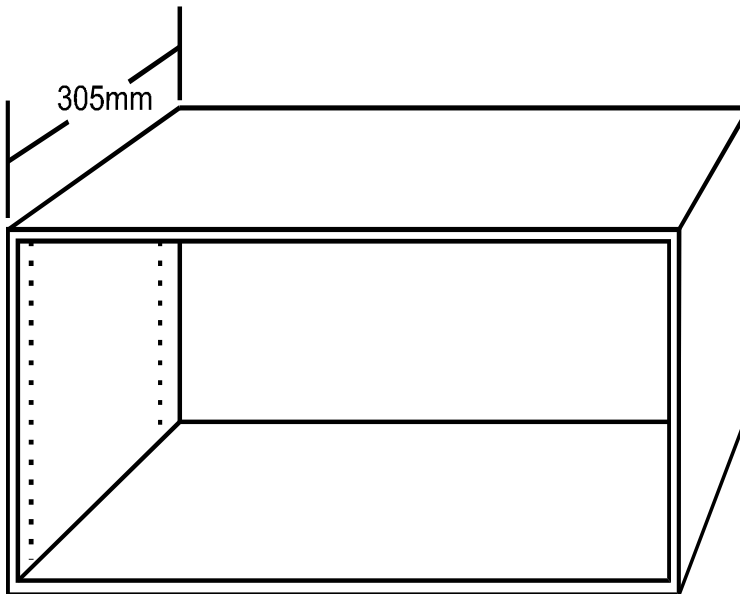

STANDARD WALL CABINET
HEIGHT 384 mm (15.11")
DEPTH 305 mm (12)

WIDTH x HEIGHT	PRICE	WEIGHT
W0915		15
W1215		17
W1515		20
W1815		23
W2115		25
W2415		28
W2715		31
W3015		33
W3315		36
W3615		39
W3915		41
W4215		44
W4515		47
W4815		49

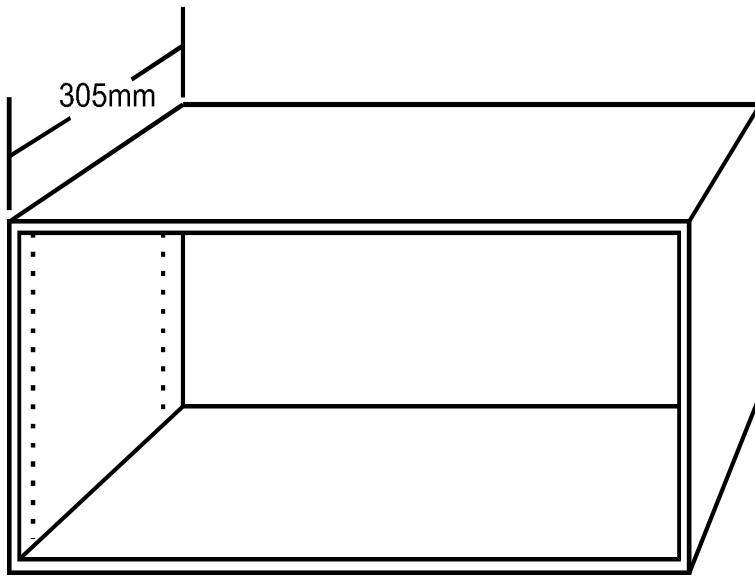

STANDARD WALL CABINET
HEIGHT 448 mm (17.63")
DEPTH 305 mm (12)

WIDTH x HEIGHT	PRICE	WEIGHT
W0918		17
W1218		19
W1518		22
W1818		25
W2118		27
W2418		30
W2718		33
W3018		36
W3318		38
W3618		41
W3918		44
W4218		47
W4518		49
W4818		52

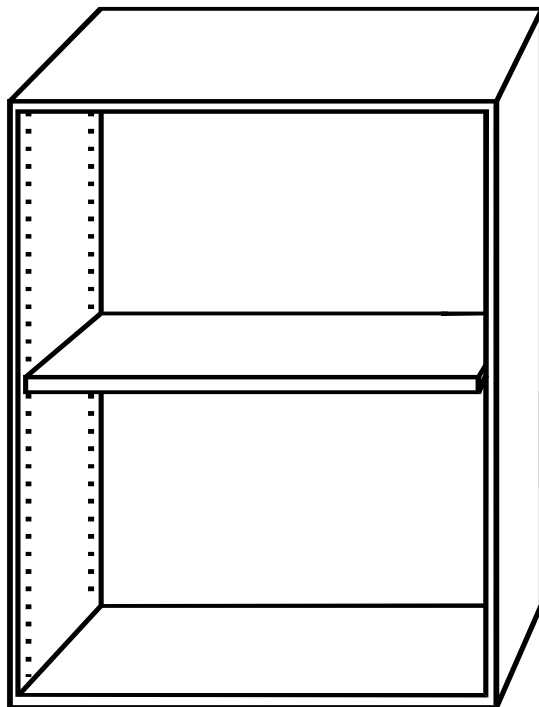

STANDARD WALL CABINET
HEIGHT 512 mm (20.15")
DEPTH 305 mm (12)

WIDTH x HEIGHT	PRICE	WEIGHT
W0921		20
W1221		24
W1521		28
W1821		31
W2121		35
W2421		39
W2721		42
W3021		46
W3321		49
W3621		53
W3921		57
W4221		60
W4521		64
W4821		68

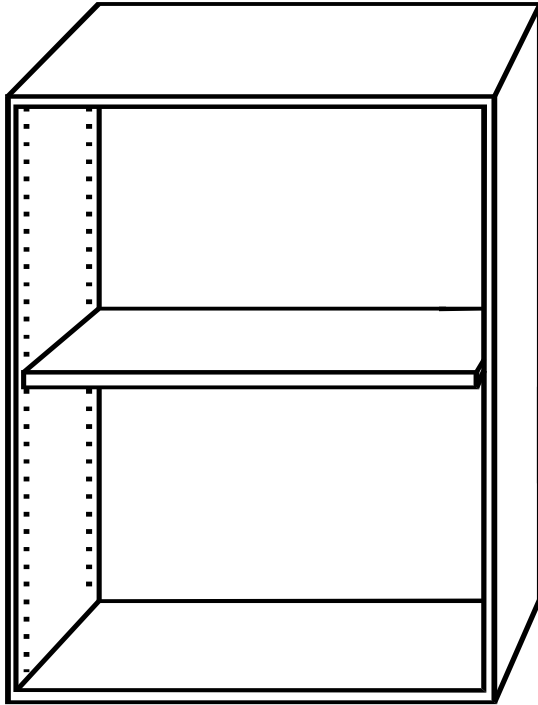

STANDARD WALL CABINET
HEIGHT 608 mm (23.93")
DEPTH 305 mm (12)

WIDTH x HEIGHT	PRICE	WEIGHT
W0924		22
W1224		26
W1524		30
W1824		33
W2124		37
W2424		41
W2724		45
W3024		48
W3324		52
W3624		56
W3924		59
W4224		63
W4524		67
W4824		70

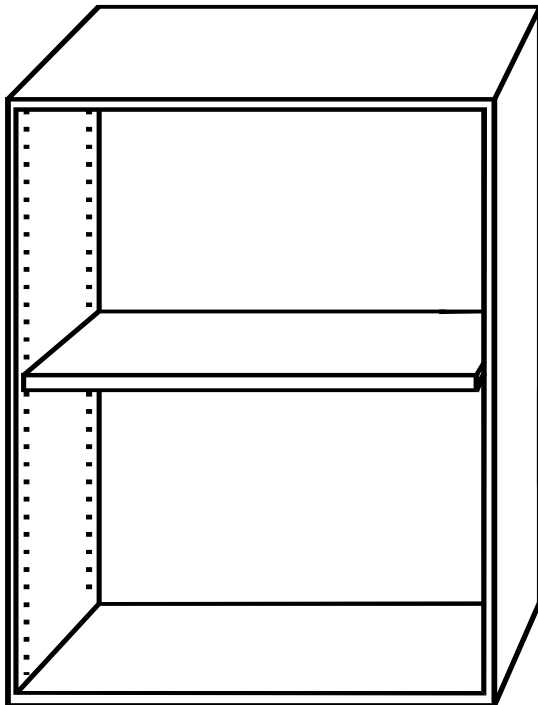

STANDARD WALL CABINET
HEIGHT 672 mm (26.45")
DEPTH 305 mm (12)

WIDTH x HEIGHT	PRICE	WEIGHT
W0927		24
W1227		28
W1527		32
W1827		35
W2127		39
W2427		43
W2727		47
W3027		51
W3327		54
W3627		58
W3927		62
W4227		66
W4527		69
W4827		73

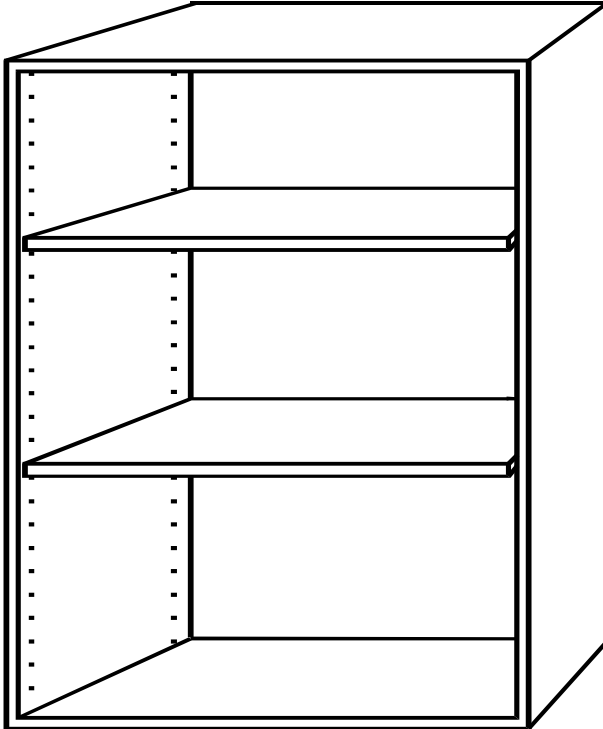

STANDARD WALL CABINET
HEIGHT 768 mm (30.23")
DEPTH 305 mm (12)

WIDTH x HEIGHT	PRICE	WEIGHT
W0930		28
W1230		33
W1530		37
W1830		42
W2130		47
W2430		51
W2730		56
W3030		61
W3330		65
W3630		70
W3930		75
W4230		79
W4530		84
W4830		89

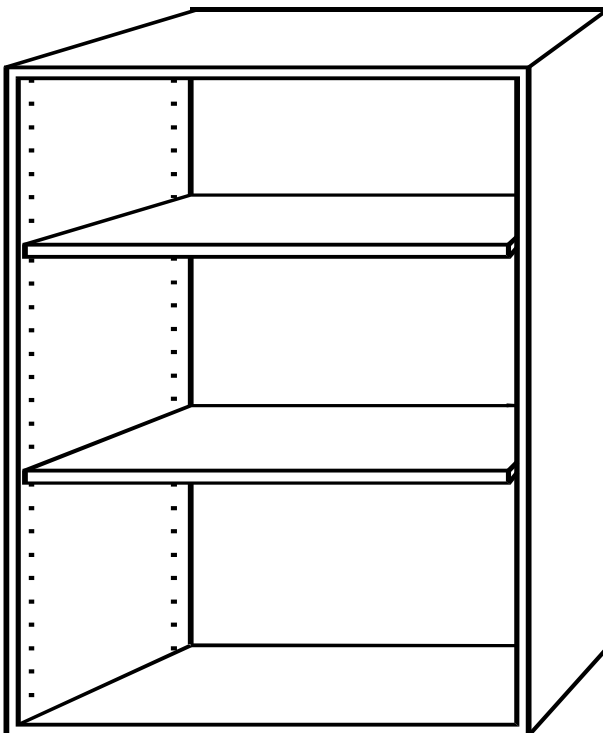

STANDARD WALL CABINET
HEIGHT 832 mm (32.75")
DEPTH 305 mm (12)

WIDTH x HEIGHT	PRICE	WEIGHT
W0933		30
W1233		35
W1533		39
W1833		44
W2133		49
W2433		54
W2733		58
W3033		63
W3333		68
W3633		73
W3933		77
W4233		82
W4533		87
W4833		92

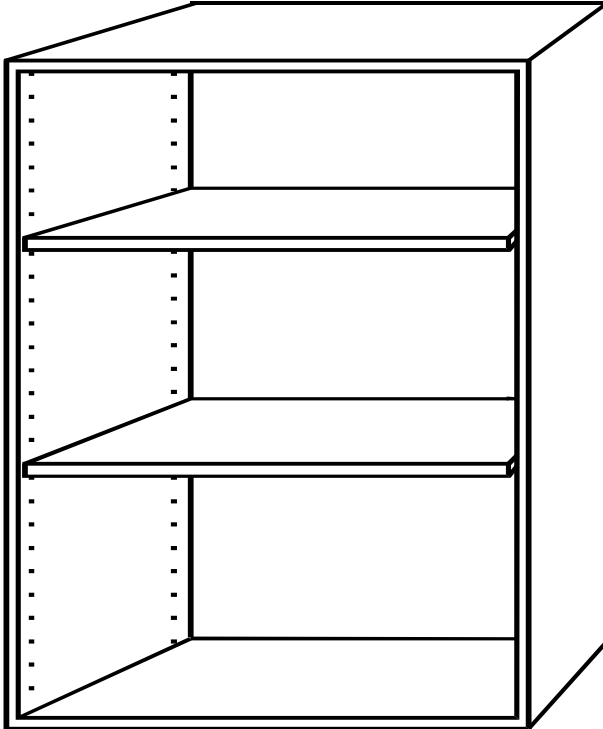

STANDARD WALL CABINET
HEIGHT 896 mm (35.27")
DEPTH 305 mm (12)

WIDTH x HEIGHT	PRICE	WEIGHT
W0936		32
W1236		37
W1536		41
W1836		46
W2136		51
W2436		56
W2736		61
W3036		66
W3336		70
W3636		75
W3936		80
W4236		85
W4536		90
W4836		94

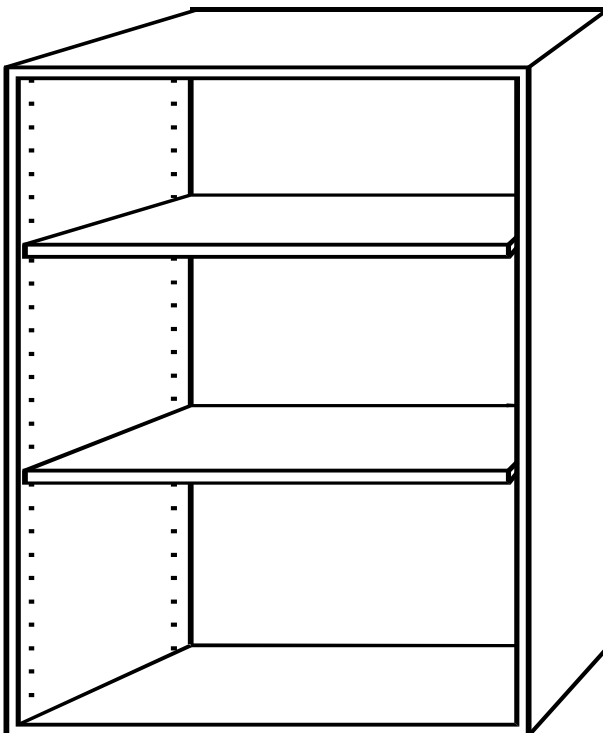

STANDARD WALL CABINET
HEIGHT 992 mm (39.05")
DEPTH 305 mm (12)

WIDTH x HEIGHT	PRICE	WEIGHT
W0939		34
W1239		39
W1539		43
W1839		48
W2139		53
W2439		58
W2739		63
W3039		68
W3339		73
W3639		78
W3939		83
W4239		87
W4539		92
W4839		97

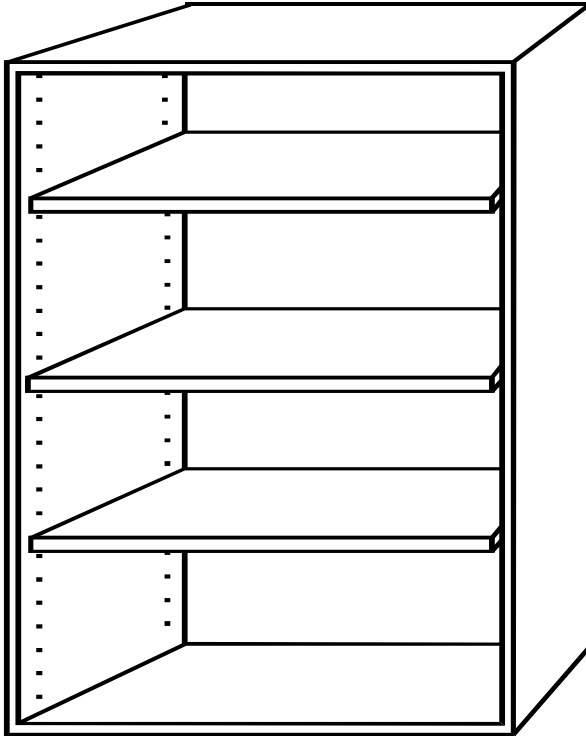

STANDARD WALL CABINET
HEIGHT 1056 mm (41.57")
DEPTH 305 mm (12)

WIDTH x HEIGHT	PRICE	WEIGHT
W0942		38
W1242		43
W1542		49
W1842		55
W2142		61
W2442		67
W2742		72
W3042		78
W3342		84
W3642		90
W3942		95
W4242		101
W4542		107
W4842		113

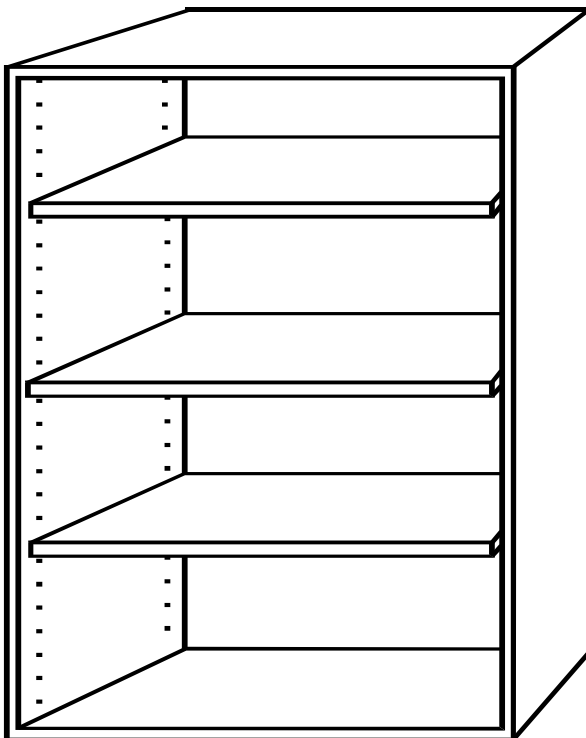

STANDARD WALL CABINET
HEIGHT 1120 mm (44.09")
DEPTH 305 mm (12)

WIDTH x HEIGHT	PRICE	WEIGHT
W0945		39
W1245		45
W1545		51
W1845		57
W2145		63
W2445		69
W2745		75
W3045		80
W3345		86
W3645		92
W3945		98
W4245		104
W4545		110
W4845		116

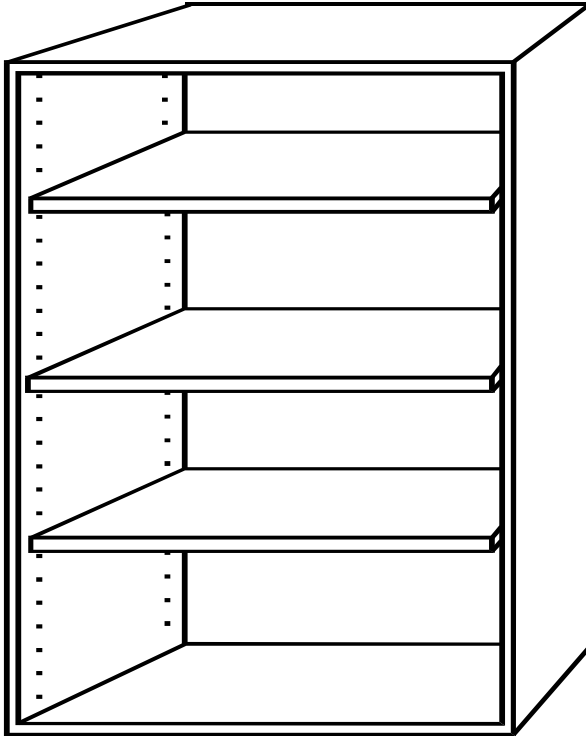

STANDARD WALL CABINET
HEIGHT 1216 mm (47.87")
DEPTH 305 mm (12)

WIDTH x HEIGHT	PRICE	WEIGHT
W0948		41
W1248		47
W1548		53
W1848		59
W2148		65
W2448		71
W2748		77
W3048		83
W3348		89
W3648		95
W3948		101
W4248		107
W4548		112
W4848		118

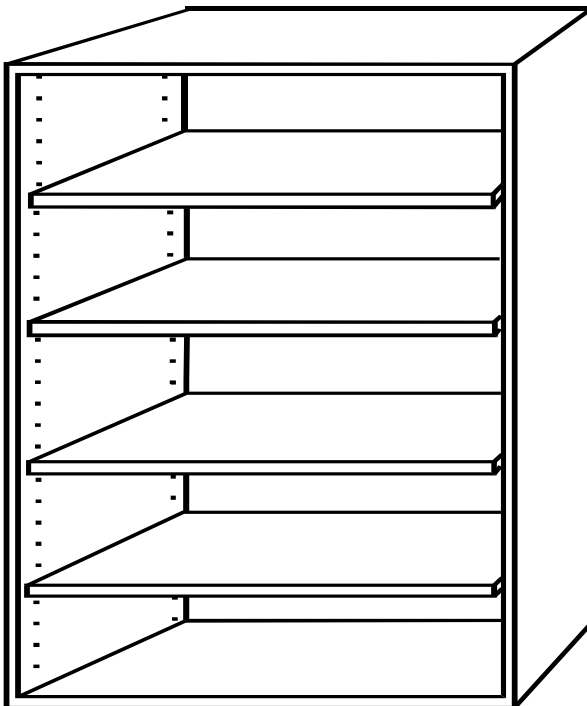

STANDARD WALL CABINET
HEIGHT 1372 mm (54")
DEPTH 305 mm (12)

WIDTH x HEIGHT	PRICE	WEIGHT
W0954		47
W1254		54
W1554		61
W1854		68
W2154		75
W2454		82
W2754		89
W3054		95
W3354		102
W3654		109
W3954		116
W4254		123
W4554		130
W4854		137

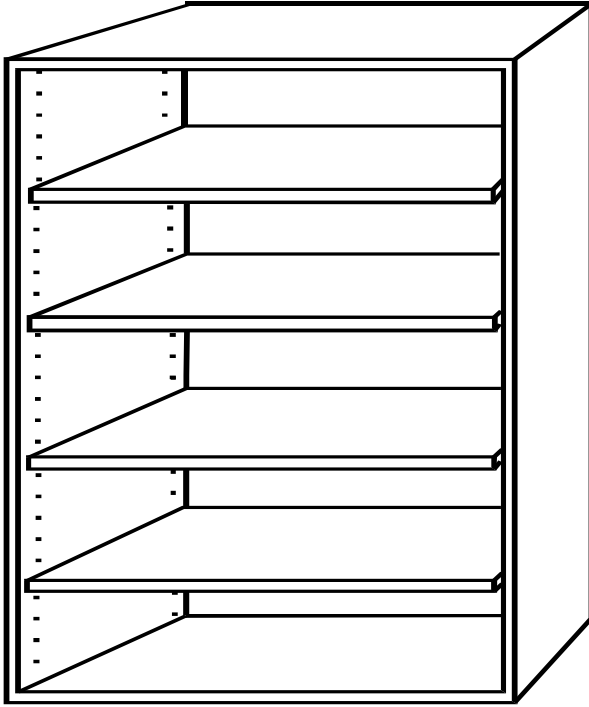

STANDARD WALL CABINET
HEIGHT 1524 mm (60")
DEPTH 305 mm (12)

WIDTH x HEIGHT	PRICE	WEIGHT
W0960		51
W1260		58
W1560		65
W1860		72
W2160		79
W2460		86
W2760		93
W3060		100
W3360		107
W3660		114
W3960		121
W4260		128
W4560		135
W4860		142

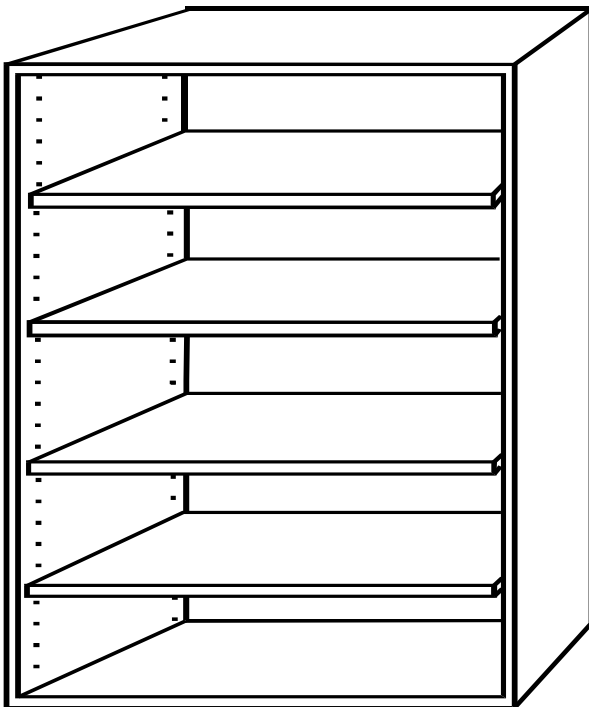

STANDARD WALL CABINET
HEIGHT 1676 mm (66")
DEPTH 305 mm (12)

WIDTH x HEIGHT	PRICE	WEIGHT
W0966		55
W1266		62
W1566		69
W1866		76
W2166		83
W2466		91
W2766		98
W3066		105
W3366		112
W3666		119
W3966		126
W4266		134
W4566		141
W4866		148

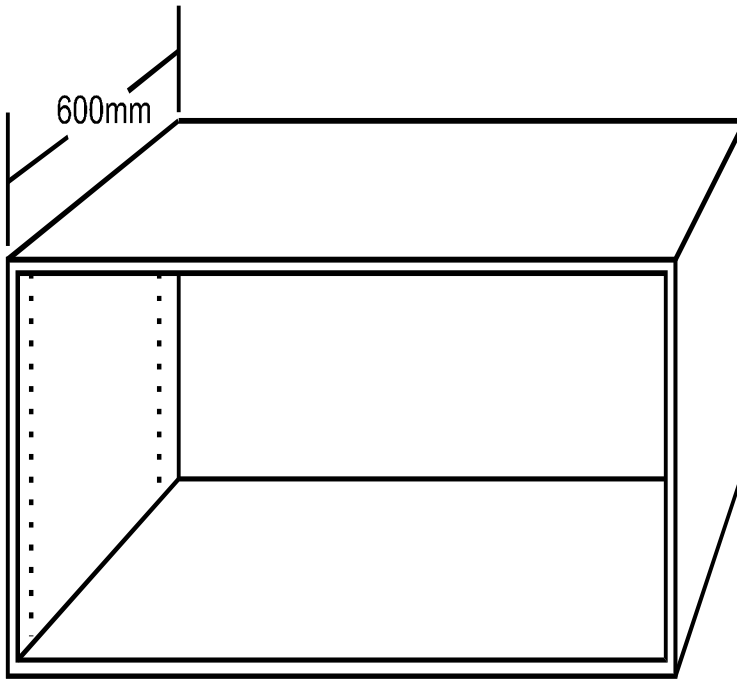

DEEP WALL CABINET
HEIGHT 288 mm (11.33")
DEPTH 600 mm (24)

WIDTH x HEIGHTxDEPTH	PRICE	WEIGHT
W1812x24		36
W2112x24		40
W2412x24		45
W2712x24		49
W3012x24		53
W3312x24		57
W3612x24		62
W3912x24		66
W4212x24		70

HEIGHT 384 mm (15.11")
DEPTH 600 mm (24)

WIDTH x HEIGHTxDEPTH	PRICE	WEIGHT
W1815x24		40
W2115x24		44
W2415x24		49
W2715x24		53
W3015x24		57
W3315x24		62
W3615x24		66
W3915x24		70
W4215x24		74

HEIGHT 448 mm (17.63")
DEPTH 600 mm (24)

WIDTH x HEIGHTxDEPTH	PRICE	WEIGHT
W1818x24		44
W2118x24		48
W2418x24		52
W2718x24		57
W3018x24		61
W3318x24		66
W3618x24		70
W3918x24		74
W4218x24		79

600mm
Deep

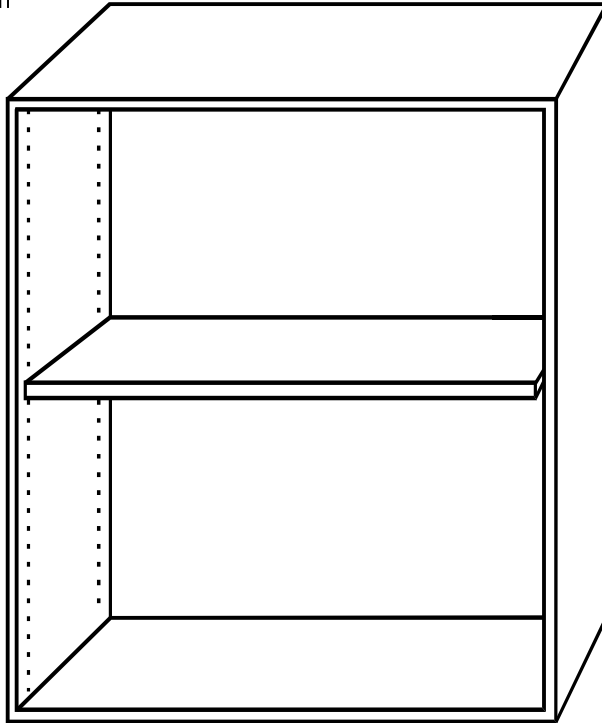

DEEP WALL CABINET
HEIGHT 512 mm (20.15")
DEPTH 600 mm (24)

WIDTH x HEIGHTxDEPTH	PRICE	WEIGHT
W1821x24		56
W2121x24		63
W2421x24		69
W2721x24		75
W3021x24		81
W3321x24		87
W3621x24		93
W3921x24		99
W4221x24		105

HEIGHT 608 mm (23.93")
DEPTH 600 mm (24)

WIDTH x HEIGHTxDEPTH	PRICE	WEIGHT
W1824x24		60
W2124x24		66
W2424x24		73
W2724x24		79
W3024x24		85
W3324x24		91
W3624x24		97
W3924x24		103
W4224x24		110

HEIGHT 672 mm (26.45")
DEPTH 600 mm (24)

WIDTH x HEIGHTxDEPTH	PRICE	WEIGHT
W1827x24		64
W2127x24		70
W2427x24		76
W2727x24		83
W3027x24		89
W3327x24		95
W3627x24		101
W3927x24		108
W4227x24		114

600mm
Deep

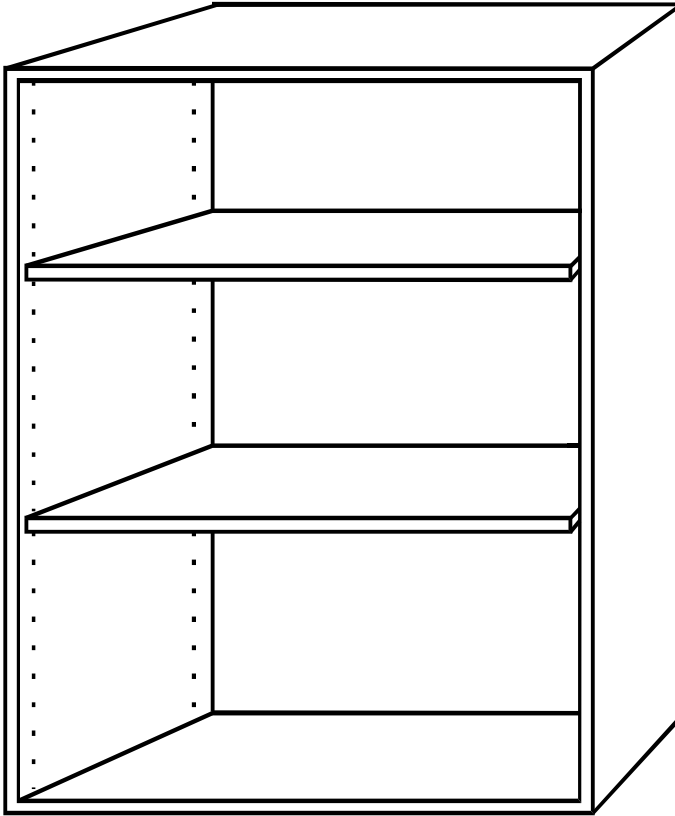

HEIGHT 768 mm (30.23")

DEPTH 600mm (24)

WIDTH x

HEIGHTxDEPTH	PRICE	WEIGHT
W1830x24		77
W2130x24		85
W2430x24		93
W2730x24		101
W3030x24		109
W3330x24		117
W3630x24		125
W3930x24		133
W4230x24		141

HEIGHT 832 mm (32.75")

DEPTH 600mm (24)

WIDTH x

HEIGHTxDEPTH	PRICE	WEIGHT
W1833x24		80
W2133x24		89
W2433x24		97
W2733x24		105
W3033x24		113
W3333x24		121
W3633x24		129
W3933x24		137
W4233x24		145

HEIGHT 896 mm (35.27")

DEPTH 600mm (24)

WIDTH x

HEIGHTxDEPTH	PRICE	WEIGHT
W1836x24		84
W2136x24		92
W2436x24		100
W2736x24		109
W3036x24		117
W3336x24		125
W3636x24		133
W3936x24		141
W4236x24		149

Wall blind corner cabinet
Shelf quantities same as
standard wall cabinets

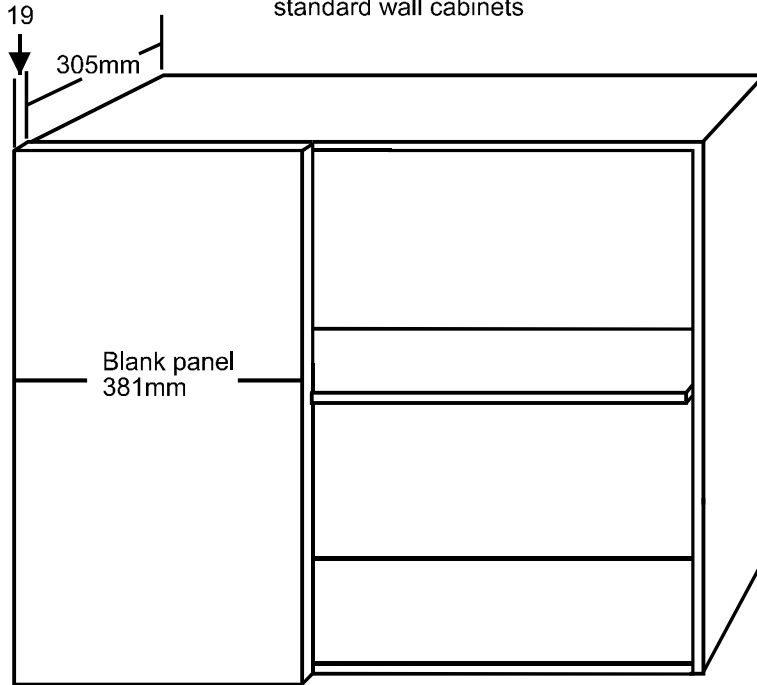

WALL BLIND CORNER
HEIGHT 608 mm (23.93")
DEPTH 305 mm (12)

WIDTH x HEIGHT	PRICE	WEIGHT
WBC2424		50
WBC2724		54
WBC3024		57
WBC3324		61
WBC3624		65
WBC3924		68
WBC4224		72

HEIGHT 672mm (26.45")
DEPTH 305 mm (12)

WIDTH x HEIGHT	PRICE	WEIGHT
WBC2427		53
WBC2727		57
WBC3027		61
WBC3327		64
WBC3627		68
WBC3927		72
WBC4227		76

Wall blind corner cabinet
Shelf quantities same as
standard wall cabinets

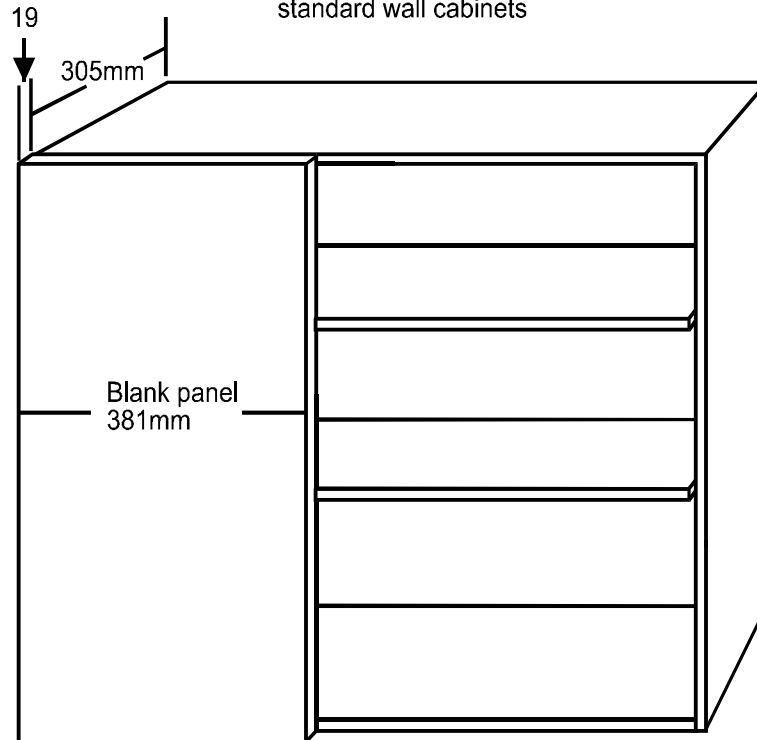

WALL BLIND CORNER
HEIGHT 768 mm (30.23")
DEPTH 305 mm (12)

WIDTH x HEIGHT	PRICE	WEIGHT
WBC2430		56
WBC2730		60
WBC3030		64
WBC3330		68
WBC3630		72
WBC3930		76
WBC4230		79

HEIGHT 832mm (32.75")
DEPTH 305 mm (12)

WIDTH x HEIGHT	PRICE	WEIGHT
WBC2433		60
WBC2733		63
WBC3033		67
WBC3333		71
WBC3633		75
WBC3933		79
WBC4233		83

Wall blind corner cabinet
Shelf quantities same as
standard wall cabinets

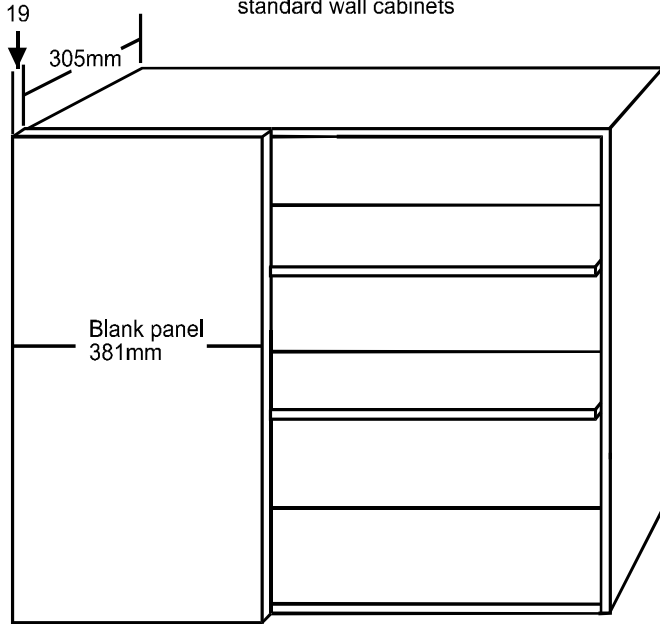

WALL BLIND CORNER
HEIGHT 896 mm (35.27")
DEPTH 305 mm (12)

WIDTH x HEIGHT	PRICE	WEIGHT
WBC2436		63
WBC2736		67
WBC3036		71
WBC3336		75
WBC3636		79
WBC3936		83
WBC4236		87

HEIGHT 992 mm (39.05")
DEPTH 305 mm (12)

WIDTH x HEIGHT	PRICE	WEIGHT
WBC2439		66
WBC2739		70
WBC3039		74
WBC3339		78
WBC3639		82
WBC3939		86
WBC4239		90

Wall blind corner cabinet
Shelf quantities same as
standard wall cabinets

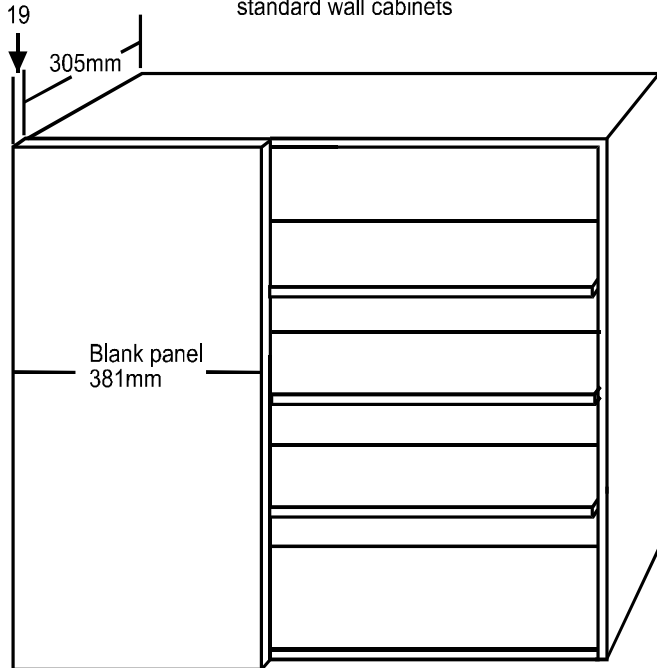

WALL BLIND CORNER
HEIGHT 1056 mm (41.57")
DEPTH 305 mm (12)

WIDTH x HEIGHT	PRICE	WEIGHT
WBC2442		69
WBC2742		73
WBC3042		78
WBC3342		82
WBC3642		86
WBC3942		90
WBC4242		94

HEIGHT 1120 mm (44.09")
DEPTH 305 mm (12)

WIDTH x HEIGHT	PRICE	WEIGHT
WBC2445		73
WBC2745		77
WBC3045		81
WBC3345		85
WBC3645		89
WBC3945		94
WBC4245		98

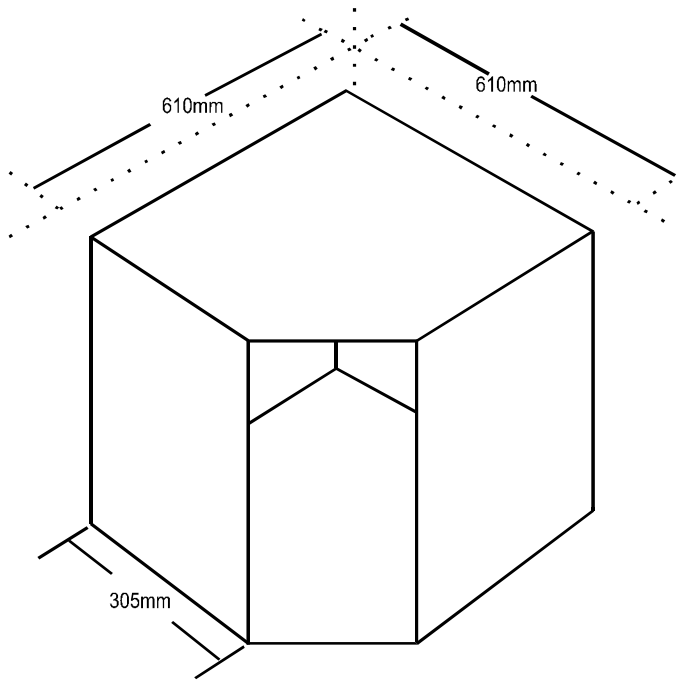

Optional Shelves-- Quantities same as Wall Cabinets

**WALL CORNER/LAZY SUSAN
45 DEGREE (NO SHELF)**

HEIGHT same as wall cabinets

DEPTH 610 mm (24)

PRICE

WEIGHT

HEIGHT x ANGLE

WC/LS24X45		53
WC/LS27X45		56
WC/LS30X45		59
WC/LS33X45		62
WC/LS36X45		66
WC/LS39X45		69
WC/LS42X45		72

**WALL CORNER/SHELF
45 DEGREE**

HEIGHT same as wall cabinets

DEPTH 610 mm (24)

PRICE

WEIGHT

HEIGHT x ANGLE

WCS24X45		66
WCS27X45		69
WCS30X45		86
WCS33X45		89
WCS36X45		92
WCS39X45		95
WCS42X45		112

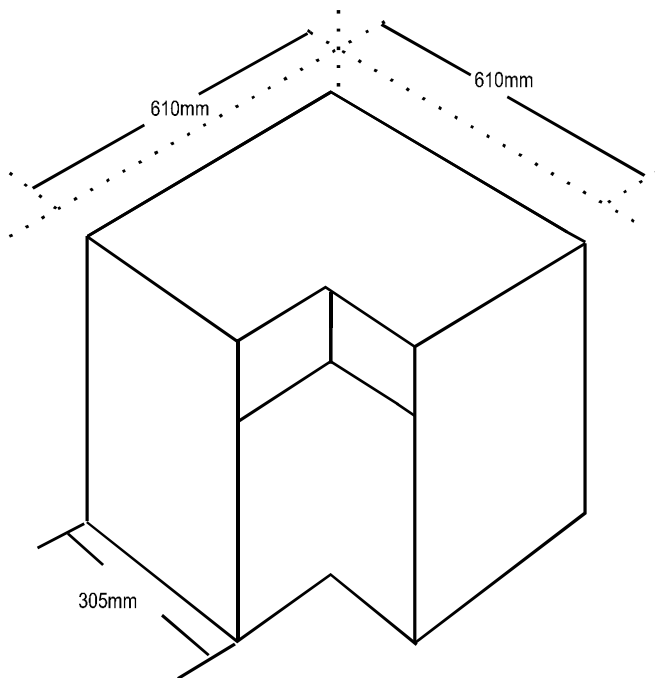

Optional Shelves-- Quantities same as Wall Cabinets

**WALL CORNER/LAZY SUSAN
90 DEGREE (NO SHELF)**

HEIGHT same as wall cabinets

DEPTH 610 mm (24)

PRICE

WEIGHT

HEIGHT x ANGLE

WC/LS24X90		53
WC/LS27X90		56
WC/LS30X90		59
WC/LS33X90		62
WC/LS36X90		66
WC/LS39X90		69
WC/LS42X90		72

**WALL CORNER/SHELF
90 DEGREE**

HEIGHT same as wall cabinets

DEPTH 610 mm (24)

PRICE

WEIGHT

HEIGHT x ANGLE

WCS24X90		66
WCS27X90		69
WCS30X90		86
WCS33X90		89
WCS36X90		92
WCS39X90		95
WCS42X90		112

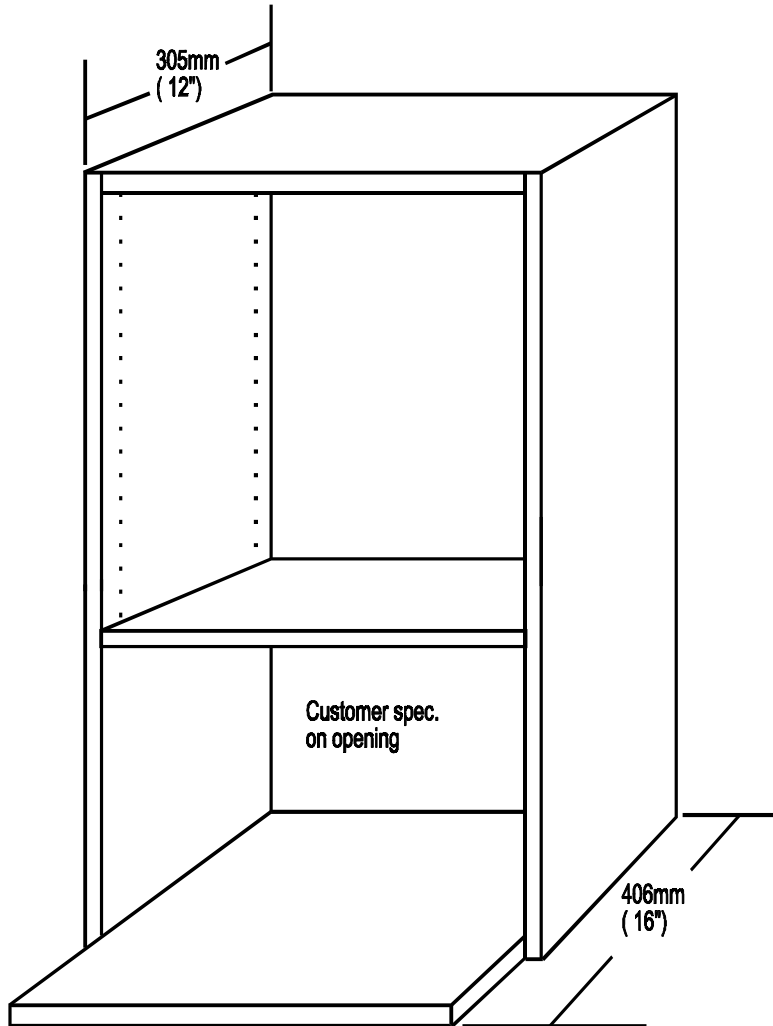

WALL MICROWAVE CABINET
HEIGHT
DEPTH 305 mm (12")

WIDTH	PRICE	WEIGHT
WMC2130		43
WMC2430		47
WMC2730		51
WMC3030		56
WMC3330		60
WMC2136		48
WMC2436		52
WMC2736		56
WMC3036		60
WMC3336		65
WMC2142		52
WMC2442		56
WMC2742		61
WMC3042		65
WMC3342		69

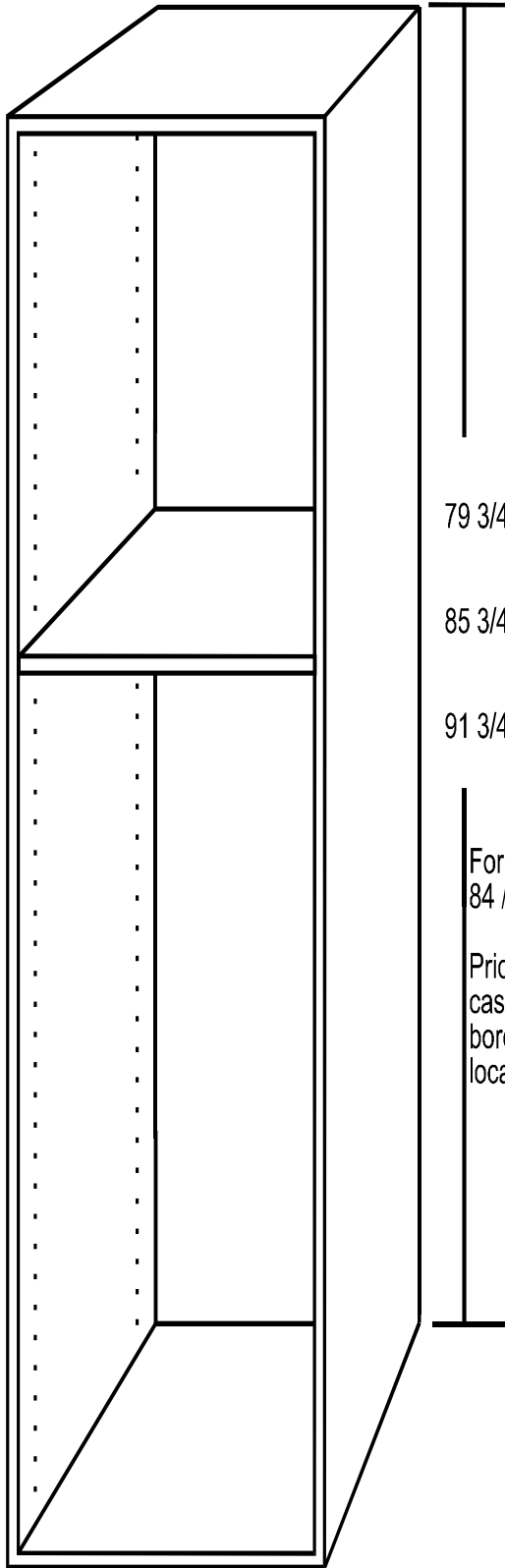

UTILITY/PANTRY
HEIGHT 79 3/4", 85 3/4", 91 3/4"
DEPTH 600 mm (23 5/8)

WIDTH x HEIGHT	DEPTH	PRICE	WEIGHT
U/P1284	24		115
U/P1584	24		122
U/P1884	24		130
U/P2184	24		137
U/P2484	24		145
U/P2784	24		152
U/P3084	24		160
U/P3384	24		167
U/P3684	24		175

79 3/4" net box size

85 3/4" net box size

91 3/4" net box size

WIDTH x HEIGHT	DEPTH	PRICE	WEIGHT
U/P1290	24		122
U/P1590	24		129
U/P1890	24		137
U/P2190	24		145
U/P2490	24		152
U/P2790	24		160
U/P3090	24		168
U/P3390	24		175
U/P3690	24		183

For catalog tall cabinets
 84 / 90 / 96

Price includes complete
 case and (1) fixed shelf
 bored at any specified
 location.

WIDTH x HEIGHT	DEPTH	PRICE	WEIGHT
U/P1296	24		129
U/P1596	24		137
U/P1896	24		144
U/P2196	24		152
U/P2496	24		160
U/P2796	24		168
U/P3096	24		176
U/P3396	24		183
U/P3696	24		191

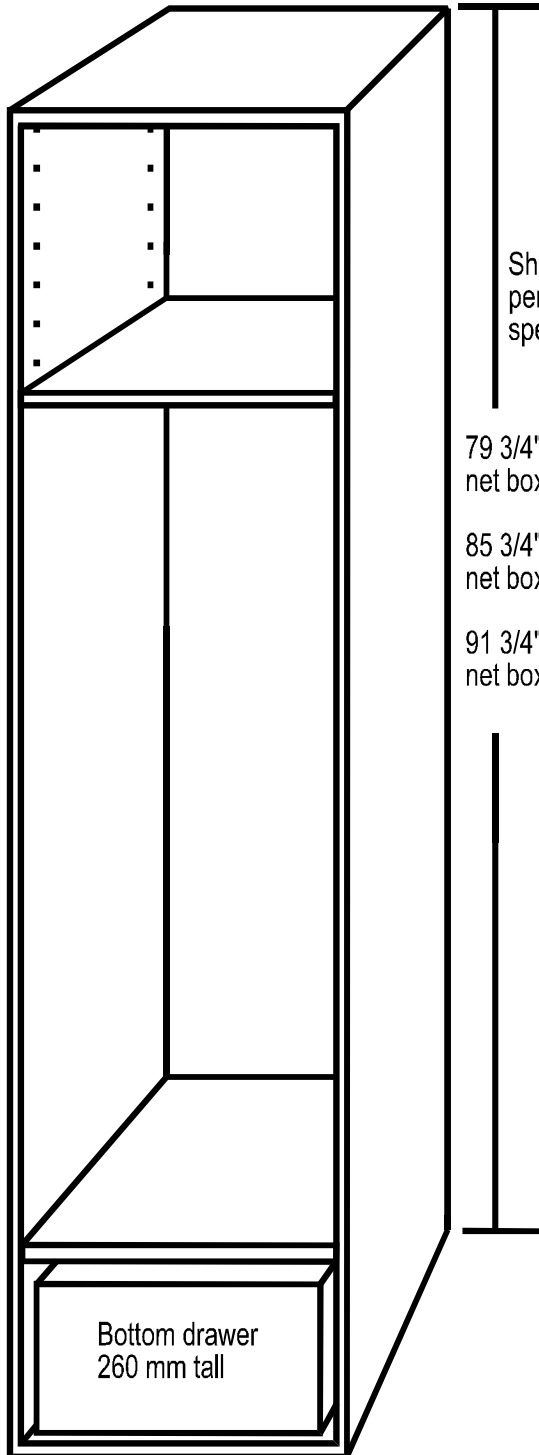

OVEN CABINET W/ DRAWER
HEIGHT 79 3/4", 85 3/4", 91 3/4"
DEPTH 600 mm (23 5/8)

WIDTH x HEIGHT	DEPTH	PRICE	WEIGHT
OVDW2784	24		189
OVDW3084	24		200
OVDW3384	24		210

Shelf placement
per / customer
specifications

79 3/4"
net box size

85 3/4"
net box size

91 3/4"
net box size

OVEN CABINET W/ DRAWER
HEIGHT 79 3/4", 85 3/4", 91 3/4"
DEPTH 600 mm (23 5/8)

WIDTH x HEIGHT	DEPTH	PRICE	WEIGHT
OVDW2790	24		197
OVDW3090	24		208
OVDW3390	24		219

OVEN CABINET W/ DRAWER
HEIGHT 79 3/4", 85 3/4", 91 3/4"
DEPTH 600 mm (23 5/8)

WIDTH x HEIGHT	DEPTH	PRICE	WEIGHT
OVDW2796	24		205
OVDW3096	24		216
OVDW3396	24		227

Bottom drawer
260 mm tall

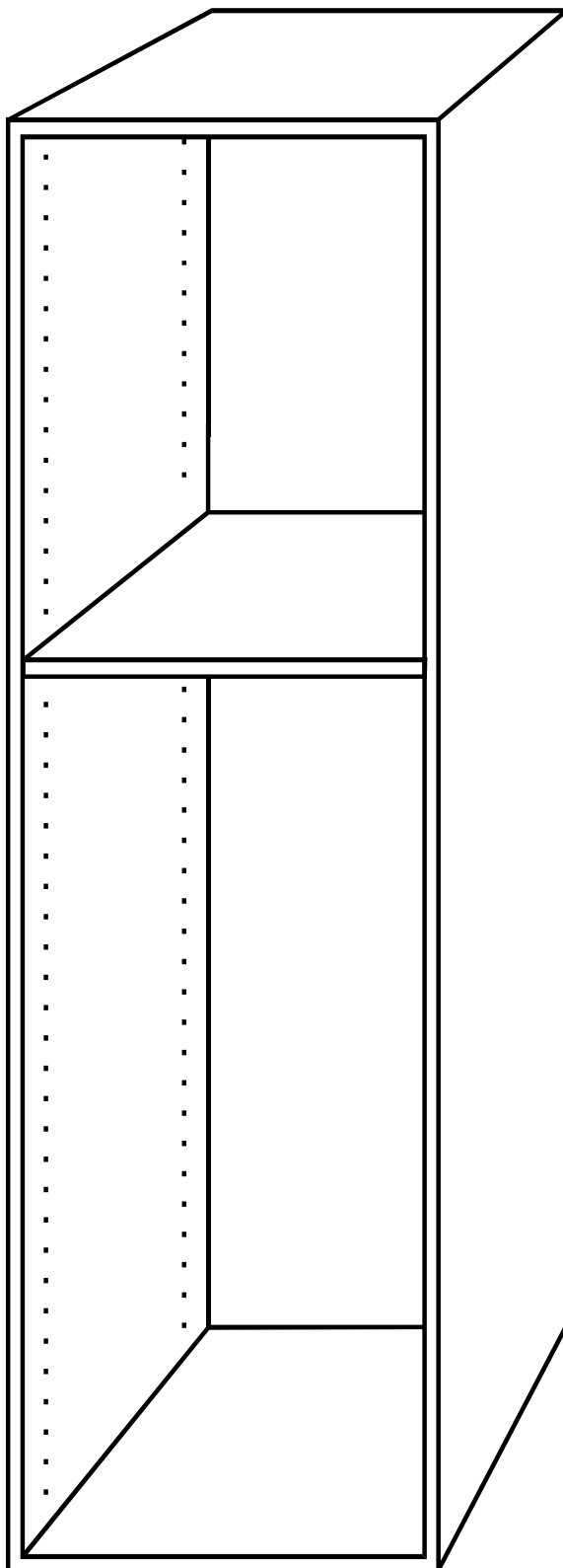

TALL CABINET
HEIGHT 79 3/4", 85 3/4", 91 3/4"
DEPTH 305 mm (12)

WIDTH x HEIGHT	DEPTH	PRICE	WEIGHT
TC1284	12		62
TC1584	12		67
TC1884	12		72
TC2184	12		77
TC2484	12		82
TC2784	12		87
TC3084	12		92
TC3384	12		97
TC3684	12		102

WIDTH x HEIGHT	DEPTH	PRICE	WEIGHT
TC1290	12		66
TC1590	12		71
TC1890	12		76
TC2190	12		81
TC2490	12		87
TC2790	12		92
TC3090	12		97
TC3390	12		102
TC3690	12		107

WIDTH x HEIGHT	DEPTH	PRICE	WEIGHT
TC1296	12		70
TC1596	12		75
TC1896	12		80
TC2196	12		86
TC2496	12		91
TC2796	12		96
TC3096	12		102
TC3396	12		107
TC3696	12		112

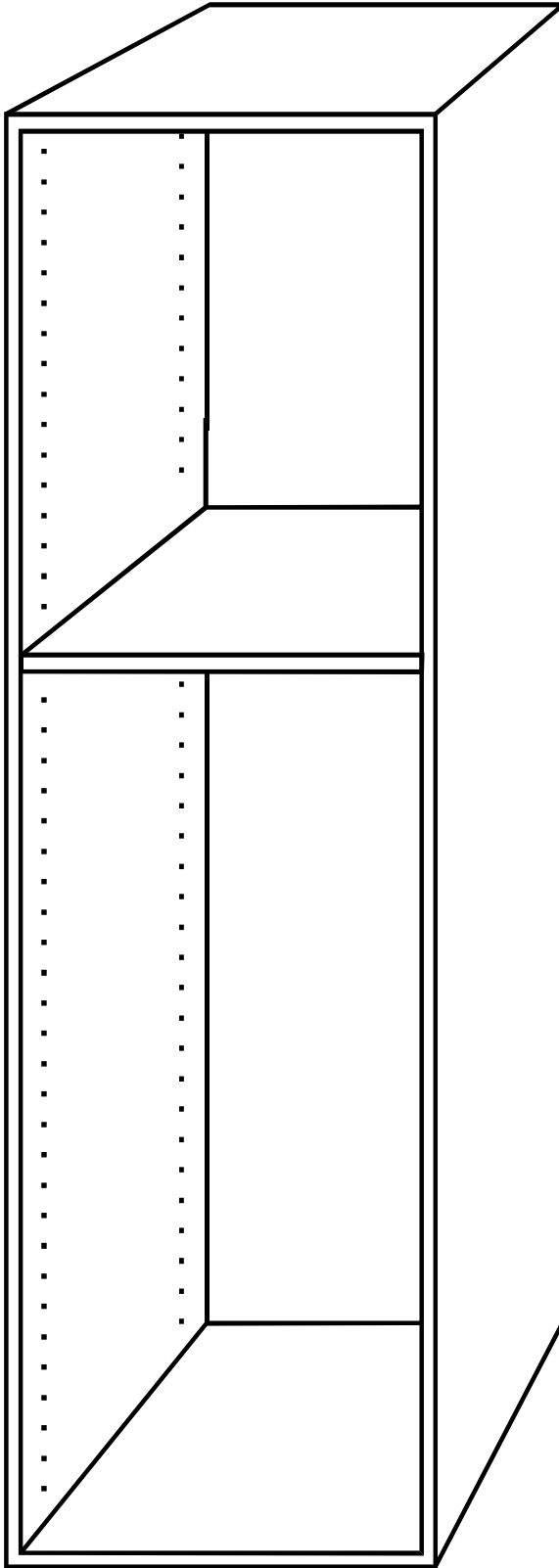

TALL CABINET
HEIGHT 79 3/4", 85 3/4", 91 3/4"
DEPTH 406 mm (16)

WIDTH x HEIGHT	DEPTH	PRICE	WEIGHT
TC1284	16		80
TC1584	16		85
TC1884	16		91
TC2184	16		97
TC2484	16		103
TC2784	16		109
TC3084	16		115
TC3384	16		121
TC3684	16		126

WIDTH x HEIGHT	DEPTH	PRICE	WEIGHT
TC1290	16		84
TC1590	16		90
TC1890	16		97
TC2190	16		103
TC2490	16		109
TC2790	16		115
TC3090	16		121
TC3390	16		127
TC3690	16		133

WIDTH x HEIGHT	DEPTH	PRICE	WEIGHT
TC1296	16		89
TC1596	16		96
TC1896	16		102
TC2196	16		108
TC2496	16		114
TC2796	16		120
TC3096	16		126
TC3396	16		133
TC3696	16		139

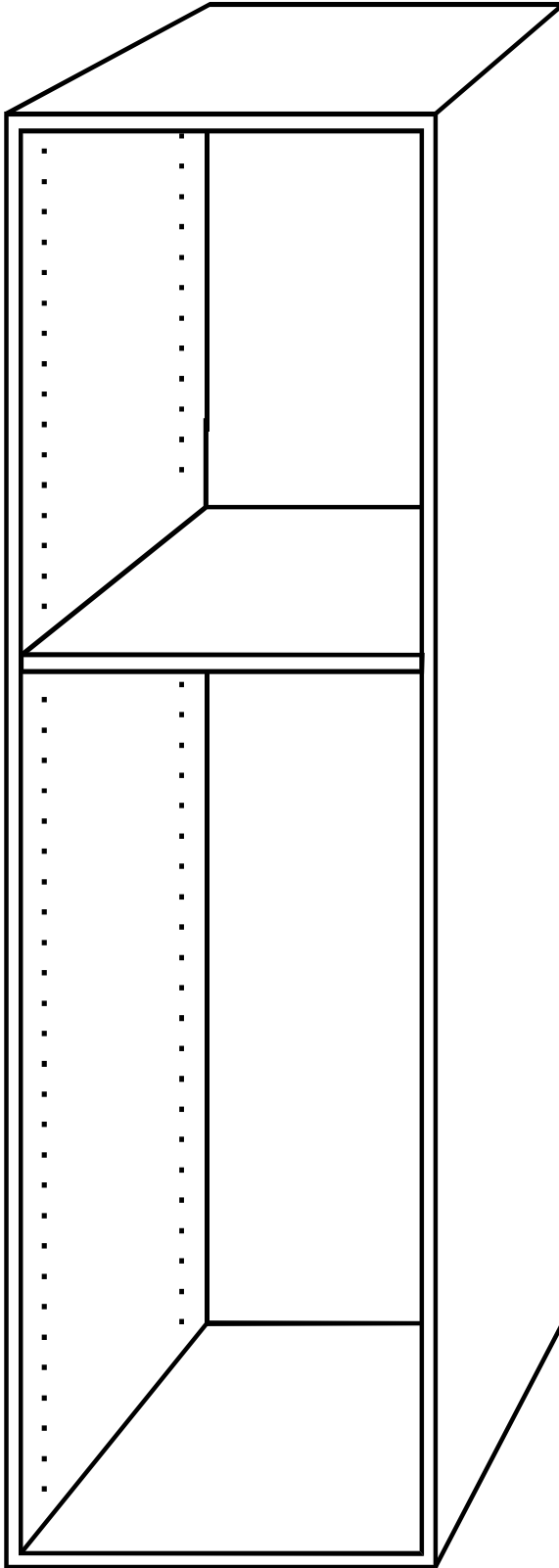

TALL CABINET
HEIGHT 79 3/4", 85 3/4", 91 3/4"
DEPTH 533 mm (21)

WIDTH x HEIGHT	DEPTH	PRICE	WEIGHT
TC1284	21		101
TC1584	21		108
TC1884	21		115
TC2184	21		122
TC2484	21		129
TC2784	21		136
TC3084	21		143
TC3384	21		150
TC3684	21		157

WIDTH x HEIGHT	DEPTH	PRICE	WEIGHT
TC1290	21		108
TC1590	21		115
TC1890	21		122
TC2190	21		129
TC2490	21		136
TC2790	21		143
TC3090	21		150
TC3390	21		157
TC3690	21		164

WIDTH x HEIGHT	DEPTH	PRICE	WEIGHT
TC1296	21		114
TC1596	21		121
TC1896	21		128
TC2196	21		136
TC2496	21		143
TC2796	21		150
TC3096	21		157
TC3396	21		164
TC3696	21		172

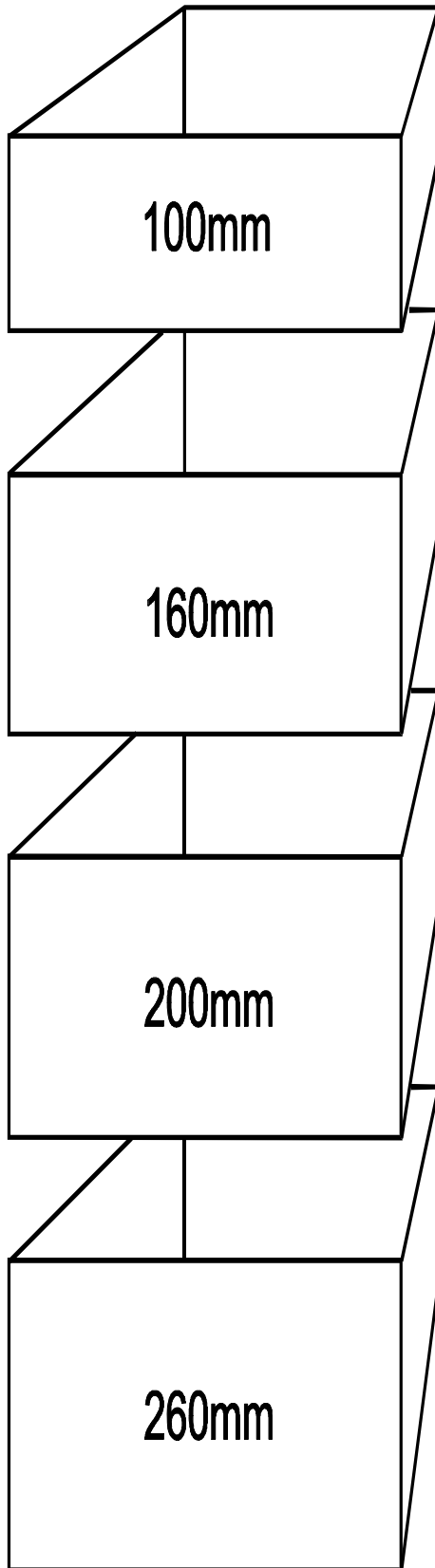

100MM DRAWER

DW	9	4	12
DW	12	4	12
DW	15	4	12
DW	18	4	12
DW	21	4	12
DW	24	4	12
DW	27	4	12
DW	30	4	12
DW	33	4	12
DW	36	4	12
DW	39	4	12
DW	42	4	12
DW	45	4	12
DW	48	4	12

PRICE WEIGHT

4
5
5
6
7
8
8
9
10
11
11
12
13
13

160MM DRAWER

DW	9	6	12
DW	12	6	12
DW	15	6	12
DW	18	6	12
DW	21	6	12
DW	24	6	12
DW	27	6	12
DW	30	6	12
DW	33	6	12
DW	36	6	12
DW	39	6	12
DW	42	6	12
DW	45	6	12
DW	48	6	12

PRICE WEIGHT

6
6
7
8
9
10
11
12
13
14
15
16
17
18

200MM DRAWER

DW	9	8	12
DW	12	8	12
DW	15	8	12
DW	18	8	12
DW	21	8	12
DW	24	8	12
DW	27	8	12
DW	30	8	12
DW	33	8	12
DW	36	8	12
DW	39	8	12
DW	42	8	12
DW	45	8	12
DW	48	8	12

PRICE WEIGHT

7
8
9
11
12
13
14
15
16
18
19
20
21
22

260MM DRAWER

DW	9	10	12
DW	12	10	12
DW	15	10	12
DW	18	10	12
DW	21	10	12
DW	24	10	12
DW	27	10	12
DW	30	10	12
DW	33	10	12
DW	36	10	12
DW	39	10	12
DW	42	10	12
DW	45	10	12
DW	48	10	12

PRICE WEIGHT

9
10
11
13
14
16
17
18
20
21
23
24
25
27

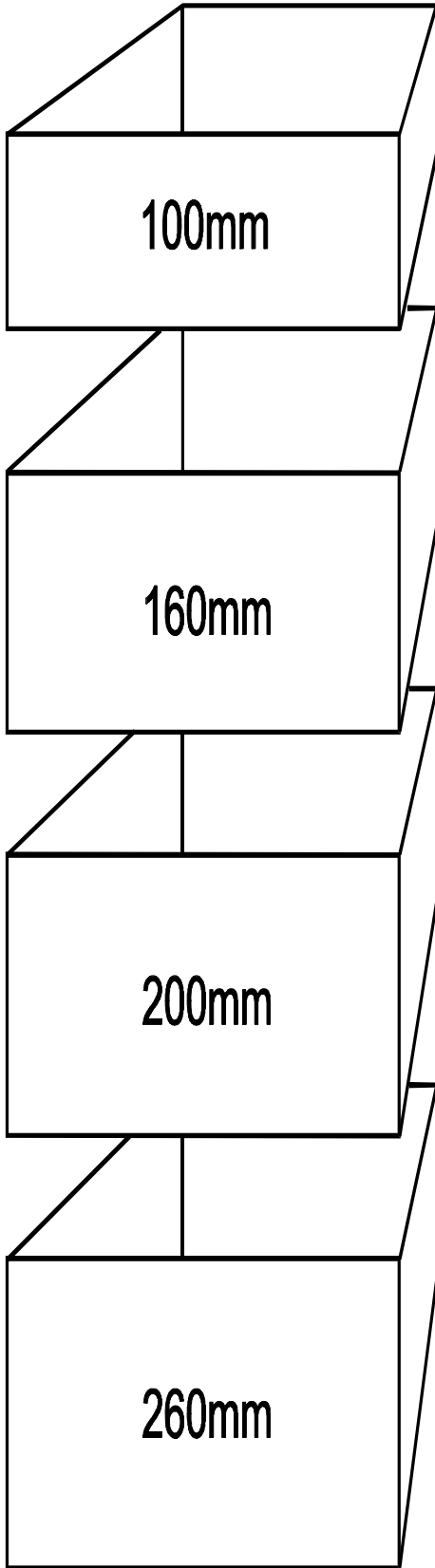

100MM DRAWER

DW	9	4	16
DW	12	4	16
DW	15	4	16
DW	18	4	16
DW	21	4	16
DW	24	4	16
DW	27	4	16
DW	30	4	16
DW	33	4	16
DW	36	4	16
DW	39	4	16
DW	42	4	16
DW	45	4	16
DW	48	4	16

PRICE WEIGHT

5
6
6
7
8
9
10
11
11
12
13
14
15
16

160MM DRAWER

DW	9	6	16
DW	12	6	16
DW	15	6	16
DW	18	6	16
DW	21	6	16
DW	24	6	16
DW	27	6	16
DW	30	6	16
DW	33	6	16
DW	36	6	16
DW	39	6	16
DW	42	6	16
DW	45	6	16
DW	48	6	16

PRICE WEIGHT

7
8
9
10
11
12
13
14
15
16
17
18
19
20

200MM DRAWER

DW	9	8	16
DW	12	8	16
DW	15	8	16
DW	18	8	16
DW	21	8	16
DW	24	8	16
DW	27	8	16
DW	30	8	16
DW	33	8	16
DW	36	8	16
DW	39	8	16
DW	42	8	16
DW	45	8	16
DW	48	8	16

PRICE WEIGHT

9
10
11
12
14
15
16
17
19
20
21
22
24
25

260MM DRAWER

DW	9	10	16
DW	12	10	16
DW	15	10	16
DW	18	10	16
DW	21	10	16
DW	24	10	16
DW	27	10	16
DW	30	10	16
DW	33	10	16
DW	36	10	16
DW	39	10	16
DW	42	10	16
DW	45	10	16
DW	48	10	16

PRICE WEIGHT

10
12
13
15
16
18
19
21
22
24
25
27
28
30

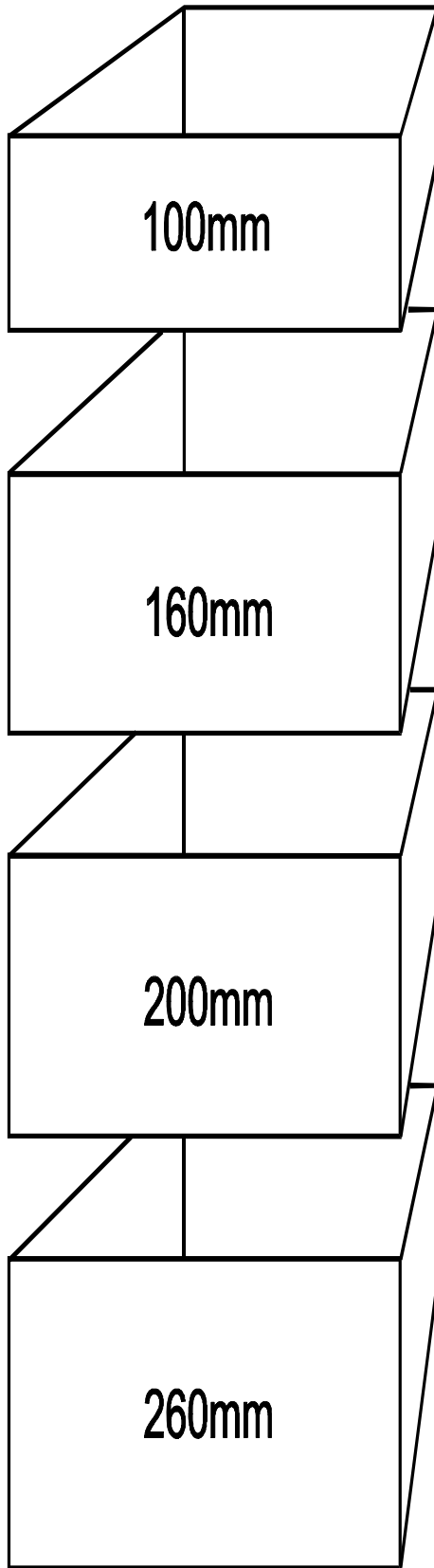

100MM DRAWER

DW	9	4	20
DW	12	4	20
DW	15	4	20
DW	18	4	20
DW	21	4	20
DW	24	4	20
DW	27	4	20
DW	30	4	20
DW	33	4	20
DW	36	4	20
DW	39	4	20
DW	42	4	20
DW	45	4	20
DW	48	4	20

PRICE WEIGHT

6
7
8
8
9
10
11
12
13
14
15
16
17
18

160MM DRAWER

DW	9	6	20
DW	12	6	20
DW	15	6	20
DW	18	6	20
DW	21	6	20
DW	24	6	20
DW	27	6	20
DW	30	6	20
DW	33	6	20
DW	36	6	20
DW	39	6	20
DW	42	6	20
DW	45	6	20
DW	48	6	20

PRICE WEIGHT

8
9
10
11
12
14
15
16
17
18
19
20
22
23

200MM DRAWER

DW	9	8	20
DW	12	8	20
DW	15	8	20
DW	18	8	20
DW	21	8	20
DW	24	8	20
DW	27	8	20
DW	30	8	20
DW	33	8	20
DW	36	8	20
DW	39	8	20
DW	42	8	20
DW	45	8	20
DW	48	8	20

PRICE WEIGHT

10
11
13
14
15
17
18
20
21
22
24
25
26
28

260MM DRAWER

DW	9	10	20
DW	12	10	20
DW	15	10	20
DW	18	10	20
DW	21	10	20
DW	24	10	20
DW	27	10	20
DW	30	10	20
DW	33	10	20
DW	36	10	20
DW	39	10	20
DW	42	10	20
DW	45	10	20
DW	48	10	20

PRICE WEIGHT

12
14
15
17
18
20
22
23
25
26
28
30
31
33

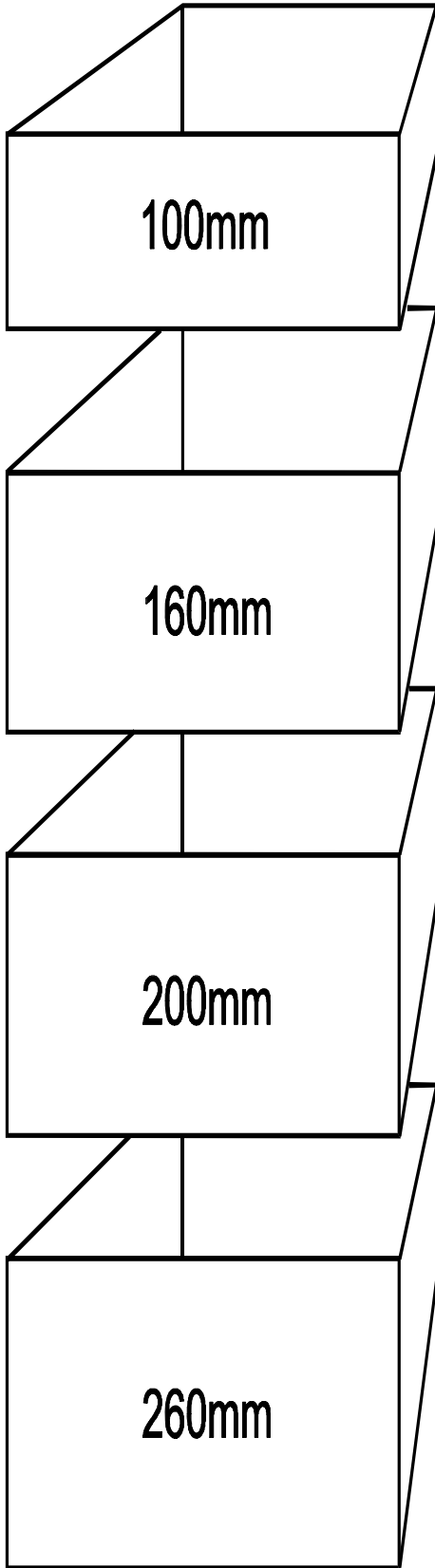

100MM DRAWER

DW	9	4	22
DW	12	4	22
DW	15	4	22
DW	18	4	22
DW	21	4	22
DW	24	4	22
DW	27	4	22
DW	30	4	22
DW	33	4	22
DW	36	4	22
DW	39	4	22
DW	42	4	22
DW	45	4	22
DW	48	4	22

PRICE WEIGHT

6
7
8
9
10
11
12
13
14
15
16
17
18
19

160MM DRAWER

DW	9	6	22
DW	12	6	22
DW	15	6	22
DW	18	6	22
DW	21	6	22
DW	24	6	22
DW	27	6	22
DW	30	6	22
DW	33	6	22
DW	36	6	22
DW	39	6	22
DW	42	6	22
DW	45	6	22
DW	48	6	22

PRICE WEIGHT

8
10
11
12
13
14
16
17
18
19
20
22
23
24

200MM DRAWER

DW	9	8	22
DW	12	8	22
DW	15	8	22
DW	18	8	22
DW	21	8	22
DW	24	8	22
DW	27	8	22
DW	30	8	22
DW	33	8	22
DW	36	8	22
DW	39	8	22
DW	42	8	22
DW	45	8	22
DW	48	8	22

PRICE WEIGHT

11
12
14
15
16
18
19
21
22
23
25
26
28
29

260MM DRAWER

DW	9	10	22
DW	12	10	22
DW	15	10	22
DW	18	10	22
DW	21	10	22
DW	24	10	22
DW	27	10	22
DW	30	10	22
DW	33	10	22
DW	36	10	22
DW	39	10	22
DW	42	10	22
DW	45	10	22
DW	48	10	22

PRICE WEIGHT

13
15
16
18
20
21
23
24
26
28
29
31
33
34



12" SHELVES

WIDTH	DEPTH	PRICE	WEIGHT
S 9	12		2
S 12	12		3
S 15	12		4
S 18	12		5
S 21	12		5
S 24	12		6
S 27	12		7
S 30	12		8
S 33	12		8
S 36	12		9
S 39	12		10
S 42	12		11
S 45	12		11
S 48	12		12

16" SHELVES

WIDTH	DEPTH	PRICE	WEIGHT
S 9	16		3
S 12	16		4
S 15	16		5
S 18	16		6
S 21	16		7
S 24	16		8
S 27	16		9
S 30	16		10
S 33	16		11
S 36	16		12
S 39	16		13
S 42	16		14
S 45	16		15
S 48	16		16

21" SHELVES

WIDTH	DEPTH	PRICE	WEIGHT
S 9	21		4
S 12	21		5
S 15	21		7
S 18	21		8
S 21	21		9
S 24	21		11
S 27	21		12
S 30	21		13
S 33	21		14
S 36	21		16
S 39	21		17
S 42	21		18
S 45	21		20
S 48	21		21

24" SHELVES

WIDTH	DEPTH	PRICE	WEIGHT
S 9	24		5
S 12	24		6
S 15	24		8
S 18	24		9
S 21	24		11
S 24	24		12
S 27	24		14
S 30	24		15
S 33	24		17
S 36	24		18
S 39	24		20
S 42	24		21
S 45	24		23
S 48	24		24

CORNER SHELVES

TYPE	PRICE	WEIGHT
CB90 S		23
CB45 S		23
WC90 S		12
WC45 S		12